

NIT NO	RBOGDK/2024-25/04
DATE	03/04/2024



STATE BANK OF INDIA

e-TENDER DOCUMENT FOR

**PROPOSED INTERIOR WORKS FOR ADB METPALLY BRANCH,
RBO GODAVARIKHANI, AO NIZAMABAD.**

(INTERIOR WORKS)

TENDER NOTICE THROUGH E-TENDERING PROCESS

**Interior Contractors who are on the panel of SBI, Hyderabad Circle, (LHO) in the
Appropriate category are only eligible (Contractors should submit proof of the
same)**

Last date for submission of e-tender: 11/04/2024 by 3.00 PM

**The Regional Manager,
State Bank of India,
Regional Business Office- II, GODAVARIKHANI ,
H.NO.5-6-174, First floor, Thirumala Complex,
NTPC, Krishna Nagar, Godavarikhani,
Dist: Peddapalli - 505215
Email: agmr2.aoniz@sbi.co.in
Phone: +91 9177318520.**

NOTICE INVITING TENDER (NIT)

**NAME OF WORK: SBI INVITES e-TENDER FOR PROPOSED INTERIOR WORKS FOR
ADB METPALLY BRANCH , RBO GODAVARIKHANI ,AO NIZAMABAD**

1	Name of the work	E-Tender Notice for PROPOSED INTERIOR WORKS FOR ADB METPALLY BRANCH , RBO GODAVARIKHANI , AO NIZAMABAD
2	Estimated cost	Rs.14,68,935/- + plus GST
3	Cost of Tender Documents	NIL
4	Quantum of Earnest Money Deposit (EMD)	Rs.15,000/- Drafts/BCs shall be in favor of “Regional Manager , RBO, Godavarikhani” Payable at Godavarikhani. Those empanelled contractors who have submitted one time EMD, have to submit the proof.
5	Date and Time where tender forms are available	03/04/2024 at www.sbi.co.in/ SBI in the News procurementnews and https://etender.sbi
6	Last date and time of submission of online Tender	11/04/2024 Upto 03:00PM
7	Place, date &time for submission of e tender Contact person /telephone no/email address.	<ul style="list-style-type: none">•Online submission up to 11/04/2024 Upto 03:00PM at https://etender.sbi•EMD& Cost of tender Document submission Address: The Regional Manager, State Bank of India, Regional Business Office- II, GODAVARIKHANI , H.NO.5-6-174, First floor, Thirumala Complex, NTPC, Krishna Nagar, Godavarikhani,Peddapalli - 505215 Email: agmr2.aoniz@sbi.co.in Phone: +91 9177318520. 11/04/2024 Upto 03:00PMContact: Chief Manager (CM &CS) Phone: +91 9177318520..
8	Date, Time and Place of opening of e-Tenders	11/04/2024 at 03:10PM The Regional Manager, State Bank of India, Regional Business Office- II, GODAVARIKHANI , H.NO.5-6-174, First floor, Thirumala Complex, NTPC, Krishna Nagar, Godavarikhani,Peddapalli - 505215

9	Quantum of Security Deposit (percentage)	1. Initial Security Deposit (ISD) – 2% of the Tender value including EMD 2. Retention Money- 5 % of the running bills and Total deduction of 5% of value of work including EMD, ISD.
10	Terms of payment of Bills, if any (specify the minimum value of work for payment of running account bills)	Minimum RA bill value Rs.8 Lakhs & Final Bill
11	Stipulated time for completion of the Work/supply.	60 Days from the date of the work order issued to the contractor.
12	(Penalty clause) Liquidated Damages	@ 0.5% of the value of work per week of delay subject to a maximum penalty of 5% of the value of work would be strictly imposed.
13	Validity period of the tender.	Three (3) Months
14	Defect Liability Period	Twelve (12) Months
15	Eligible Taxes	A)Income Tax & GST IT will be deducted at source as per Govt. Guidelines. •Reimbursement of GST will be made only on submission of proper GST invoice as per applicable GST provision .The contractor should comply with the following; <ul style="list-style-type: none"> • Contractor should have GST Registration Number • Invoice should specifically/separately disclose the amount of GST levied at applicable rate as per GST provision • In case of Correction in the bills after scrutiny,contractor should submit fresh bills forpayment • Contractor should timely file his GST return inaccordance with GST provisions to enable the bank to claim the credit of GST paid to thecontractor • The GST Number of State Bank of Indiaare For Telangana State -36AAACS8577K1ZQ
16	Electronic Payment	Payment shall be made by way of Electronic fund transfer and the bill will be paid by the Branch. Firm should furnish details of the bank, a/c no, IFSC code

17	Agency for arranging online bidding	<p>e-Procurement technologies Limited, Ahmedabad. Primary Contact: Ms. Geeta 079-68136810 ,geeta@auctiontiger.net</p> <ul style="list-style-type: none"> • Anshul Juneja:- 079-68136840,anshul.juneja@eptl.in • Kanchan Kumari:- 079-68136820, kanchan.k@eptl.in • JaymeetRathod:- 079-68136829,jaymeet.rathod@eptl.in • SalinaMotani:- 079-68136843, salina.motani@eptl.in • VinayakKhambe:-079-68136835,vinayak.k@eptl.in • ImtiyazTajani:- 079-68136831, imtiyaz@eptl.in • HemangiPatel:- 079-68136852, hemangi@eptl.in • Nadeem Mansuri:-079-68136853,nadeem@eptl.in • Deepak Narekar:- 079-68136863, deepak@eptl.in • SujithNair:- 079-68136857, sujith@eptl.in • DevangPatel:- 079-68136859, devang@eptl.in
18	Any additional Information	<p>The quoted rate should be inclusive of materials, labour, wages, fixtures, transportation, installation, all taxes (excluding GST), wastage, Octroi, machinery, temporary works such as scaffolding, cleaning, overheads, profit, statutory expenses, incidental charges and all related expenses to complete the work</p>
19	EVALUATION OF PRICE BIDS AND FINALIZATION	<ul style="list-style-type: none"> •Only those Bidders who qualify in Technical evaluation would be shortlisted and the online price bid submitted by the bidder will be opened. •The L1 Bidder will be selected on the basis of net total of the price evaluation as quoted in the Online bidding or Reverse Auction (if conducted). •In case, the L1 amount quoted by two or more contractors is the same, such lowest contractors will again be asked to submit sealed / online “Revised price bid” on the original Estimated Cost of tender but the revised price bid shall, in no case, be higher than the price quoted during their initial offer for the project. The L1 shall be decided on the basis of revised offers.

		<ul style="list-style-type: none"> •The process of online rebidding amongst the two or more contractors offering same rates shall continue till L1 bidder is discovered. If required, SBI shall conduct reverse auction to discover the L1 bidder. • In case, any of such contractors or all contractors (who have quoted same tender amount in the initial bidding or subsequent bidding) refuse to submit revised offer, it shall be treated as “Withdrawal of tender” by the Contractor before acceptance by SBI and the EMD of such contractors shall be forfeited and they shall not be allowed to participate in the re-tendering process for the work. •If the final L1 bid is unreasonably low ie L1 bid is less by 10% or more of the Estimated Cost, the contractor shall submit additional Security Deposit in the form of PBG/DD for an amount equal to difference in the estimated cost vis-a-vis final tender amount quoted by the L1 contractor. PBG/DD to be submitted within 7 days from issue of letter from Bank. •If the L1 bidder refuses to give the PBG, then the EMD will be forfeited and the tender will be re-invited. The L1 bidder will not be allowed to participate in the retendering process. •Additional Security deposit (ASD)/Additional performance Guarantee (APG) shall be applicable if the bid price is below 7.5 % of the estimated cost put to tender. The amount of such ASD/ APG shall be the difference between 92.5 % of estimated cost put to tender and the quoted price.
--	--	--

Following documents to be scanned and uploaded:-

- Scanned copy of Tender cost and EMD must be uploaded and the same needs to be submitted at given address within due date of tender.
- Firm should be visit the website (<https://etender.sbi>) till last date of submission for changes. corrigendum if any will be published only in <https://etender.sbi>
- L-1 Tenderer signed copy of entire tender document should be submit within 3 days from date of tender opening.

Sd/-
REGIONAL MANAGER, STATE BANK OF INDIA

INSTRUCTIONS TO TENDERERS

• Online, e tenders are invited in online single bid for **PROPOSED INTERIOR WORKS FOR ADB METPALLY BRANCH, RBO GODAVARIKHANI, AO NIZAMABAD.**

- Submission of BIDs/Tender Documents: Tenders should be submitted online in the website <https://etender.sbi>. In addition, scanned copy of the declaration given in the tender to be signed with seal and scanned proof of dealership/empanelment letter certificate should be submitted online with our service provider on the website at: <https://etender.sbi>. The tender document is not required to be sent to us in hard copy.

Contractors should submit/sent **EMD should be submitted physically within due date of the tender** at the office of the **The Regional Manager, State Bank of India**, Regional Business Office- II, GODAVARIKHANI, H.NO.5-6-174, First floor, Thirumala Complex, NTPC, Krishna Nagar, Godavarikhani, Peddapalli - 505215. The tender will be rejected if the tenderer fails to submit the above documents scanned copies of Dealership certificate, EMD and Cost of tender document.

- Contract documents consist of detailed plans, technical specification, schedule of quantities of the various classes of work to be done, and the set of 'conditions of contract' to be compiled with by the person whose tender may be accepted. The documents are available in the website <https://etender.sbi>

- Tenders should be submitted online **(As mentioned in NIT)**.

• **EMD amount (As mentioned in NIT)** is to be deposited in the form of Demand Draft/ Banker's Cheque payable at **GODAVARIKHANI** and drawn in favor of State Bank of India, Godavarikhani, otherwise the tender is liable for rejection.

• The successful tenderer will have to pay an amount of Initial Security Deposit, which shall be 2% of the accepted value of the tender, by means of D.D. in favor of **State Bank of India, Godavarikhani**. The Initial security deposit is to be paid by the Contractor to Bank within 7 days of intimation to him of the acceptance of the tender. No interest is allowed on the above said security deposit (EMD, ISD),

- Retention Money: From each running bill, an amount at the rate of 5% of the gross value of the running bill shall be recovered as retention money, till the total retention amount including the EMD and ISD amounts already with the Bank become 5% of the value of the contract amount.

This amount is called as Total Security Deposit, which consists of three components

- EMD - Earnest Money Deposit.
- ISD - Initial Security Deposits.
- RM - Retention Money.

The total security deposit will be kept with the Bank. And total security deposit may be refunded after the end of defects liability period (**one year**), provided he has satisfactorily carried out all the works and attended to rectification of all defects in accordance with the conditions of the contract. In case of failure on the part to do so, the cost of rectifying the defects through any other agency shall be deducted from the amount of security deposit due to the contractor.

- Completion of work:
 - The work shall be considered as complete only when the certificate of virtual completion is issued by the architects/Bank.
 - The 'defects liability period' as prescribed in the contract shall commence only from date of such virtual completion.
 - Any defect that may appear within the defects liability period shall be rectified by the contractor within reasonable time on receipt of necessary instructions from Bank to that effect.
- The acceptance of a tender will rest with the Competent Authority, who does not bind himself to accept the lowest tender and reserves to himself the authority to reject any or all the tenders received, without assigning any reasons. All tenders in which any of the prescribed conditions are not fulfilled or are incomplete in any respect are liable to be rejected.
- All compensation or other sums of money payable by the Contractor to Clients under the terms of this contract may be deducted from the security deposit, or from any sum that may be or may become due to the Contractor on any account whatsoever and in the event of the Security Deposit being reduced by reasons of any such deductions, the Contractor shall within 7 days of being asked to do make good in by DD any sum which have been deducted from his security deposit.
- Tender containing any condition leading to unknown / indefinite liability, are liable to be summarily rejected.
- Canvassing in connection with tenders is strictly prohibited and the tenders submitted by the contractors who resort to canvassing will be liable to rejection.
- The tenderer should quote their (own) rates for undertaking the work.
- GST as applicable will be reimbursed by Bank as specified in NIT.
- All taxes other than GST, other statutory obligation in respect of this contract, as applicable, shall be payable by contractor including transportation and TA / DA of the workers at site and the Bank will not entertain any claim whatsoever in this respect
- I.T. will be recovered as per Government Rules
- Time is the essence of the contract. The work should be completed on time as mentioned in the NIT. The successful Contractor will have to give CPM/PERT chart of various activities of works to be done so that the work gets completed within the

stipulated time. The chart shall be submitted within 7 days from the date of acceptance of the tender.

- Tenders for works shall remain open for acceptance for a period of 90 **days** from the last date of tenders. If the tenderer withdraws his tender before the expiry of the said period or makes any modifications in terms and condition of the tender which are not acceptable to the Bank, then the bank without prejudice to any other right or remedy is at liberty to forfeit the earnest money.
- The successful tenderer, after the work is awarded, he will have to enter into an agreement with the competent authority of the bank.
- The tenderer must co-ordinate with the other agencies such as Interior/Civil/Electrical/IT/Fire/AC etc.
- The tenderer should visit the site to ascertain the working conditions and local authority regulations / restrictions if any and other information required for the proper execution of the work.
- The work may be carried out on any floor level as per site condition. Please note that materials and machines are required to be carried on head load and the same must be accounted in the costing. Please note that no separate cost shall be allowed for head load.
- The quantities of various items given in the schedule of quantities are approximate. The quantities of work may vary at time of allotment / execution of work. Bank reserves the right to omit / delete any item(s) of work from the schedule at the time of allotment / before. Contractor will be paid for the actual work done at the site duly verified by the concerned official of the bank.
- The unit price shall be deemed to be fixed price. In case of extra items, a record of labour charges paid shall be maintained and shall be presented regularly to the Employer's for checking. The settlement will be made based on figures arrived at jointly and taking unit price given in the contract assigned to the successful Tenderer. In case of extra items where similar or comparable items are quoted in the tender, extra rates shall be based on tender rates.
- If the rate quoted by the contractor for any item / items are not workable or abnormally lower than the market rate, the bank may demand Bank guarantee from the contractor for satisfactory completion of these work. The bank guarantee amount will be not less than 50% of the estimated amount of the items for which the rates are not workable or abnormally low. This bank guarantee will be released after completion of these works (unworkable and abnormally low rated items) to the satisfaction of the bank.
- The contractor shall submit the bar chart/ CPM/ PERT as well as shall submit the insurance cover for the work in the form of CAR policy and Third-Party Insurance within seven (7) days from the acceptance of work order.

- The work must be started within immediately from the date of receipt of work order/ mark out at site; whichever is later. In case of work not being started within this stipulated period, the bank reserves the right to cancel the work order duly forfeiting the Earnest money deposit
- No employee of the Bank is allowed to work as a contractor for a period of 2 years of his/her retirement from Bank Services without previous permission of the Bank. This contract is liable to be cancelled, if either the contractor or any of his employees is any time to be such a person who had not obtained the permission of Bank as aforesaid before submission of the tender or engagement in the contractor's service.
- Contractor should get approval of the samples of materials in advance with Bank's Engineer before use of the same in the work'
- Bank has the right to offer the contractor to modify the old material wherever/ whenever necessary instead of new supplies
- The quoted rate should be inclusive of materials, labour, wages, fixtures, transportation, installation, all taxes(excluding GST), wastages, Octroi, machinery, temporary works such as scaffolding, cleaning, overheads, profit, statutory expenses, incidental charges and all related expenses to complete the work
- The tenders shall summarily have rejected, if any one of the above said requirements has not been complied with.
- The Bank will not be bound to accept the lowest tender and reserves the right to accept or reject any or all the tenders without assigning any reason whatsoever
- The contractor should fulfill the labour regulation guidelines stipulated by the governments
- No advance payment in any form will be granted for the works proposed
- Period of taking up the final bill will be one month from/ after satisfactory virtual completion or the date of submission of the final bill whichever is later.
- Contractor is advised **not to engage child labour during the contract period**
- The SBI reserves the right to cancel or postpone the tenders at any stage without assigning any reason.
- Firm should be visit the website till last date of submission for changes/ corrigendum if any
- Tender documents found partly or fully modified / altered/ corrected etc shall stand summarily rejected
- The make of materials should be chosen strictly from the approved makes as given in the tender. Using of the multi brands is not permissible. Single brand should be used for entire project.

- ANY CLARIFICATIONS SOUGHT AFTER OPENING OF THE TENDERS WILL NOT BE ENTERTAINED AT ANY COST.

**REGIONAL MANAGER,
STATE BANK OF INDIA**

FORM OF SUBMISSION OF TENDER
(To be filled by the tenderer)

The Regional Manager,
State Bank of India,
RBO – II, Godavarikhani ,
First floor, Thirumala Complex,
NTPC, Krishna Nagar, Godavarikhani,
Dist: **Peddapalli – 505215.**

Dear Sir,

REF: PROPOSED INTERIOR WORKS FOR **ADB METPALLY BRANCH, RBO
GODAVARIKHANI, AO NIZAMABAD.**

I/We hereby declare that I/ We have carefully gone through the conditions laid down in the Notice Inviting Tender, General notes, General Conditions of Contract, Special conditions, Schedule of approximate quantities and rates, Form of Agreement, General Specification, Approved manufacturers/ natural source of materials Technical Specifications of schedule of quantities, and clearly understood all the same and on the basis of the same I/ We have quoted our rates in the Schedule of Quantities (i.e. BOQ) attached with the tender documents.

I / We do here by undertaken to execute and complete the whole or part of the work (as desired by you) at the respective rates quoted.

I/ We are depositing Tender cost & Earnest Money Deposit (Amounts as per NIT) by way of demand draft drawn in favor of SBI, Godavarikhani; along with this tender for due execution of the work at my/ our tendered rates.

In the event of this Tender being accepted I/ We agree to enter into the agreement and submit the declaration on requisite non-judicial stamp papers as and when required and execute the contract according to your form of Agreement etc., in default whereof, I/ We do hereby bind my-self / ourselves to forfeit the aforesaid deposit.

In the event of this Tender being accepted I/ We agree to obtain the labor license and the CAR and Third party insurance policy and deposit the balance E.M.D. amount and adhere/comply to all other instructions as given in TENDER DOCUMENT.

I / We further agree to complete the work included in the said schedule of quantities as mentioned in NIT from the date of the work order issued to commence the same.

Date of commencement shall be either one week from the date of work order issued to the contractor or the date on which mark out of work at site has been given to contractor; whichever is later.

I / We agree not to employ sub-contractors other than those that may be approved by Employer.

I / We agree to pay all taxes(except GST), insurance charges as prevailing from time to time, on such items for whom same is to be levied by/ for the government, and the rates quoted by me / us are inclusive of all the same.

Yours Faithfully,

Contractor's Signature

Name:

Address:

Signature of Witness:

1. _____

2. _____

GENERAL NOTES

•PROCEDURE OF FILLING AND SUBMISSION OF TENDER

- Submission of BIDs/Tender Documents: Tenders should be submitted online in the website <https://etender.sbi>. In addition, scanned copy of the declaration to be signed with seal and scanned proof of valid dealership certificate should be submitted online with our service provider on the website at: <https://etender.sbi>.
- In the event of the tender being submitted by a firm, it must be signed by a member or members of the firm having legal authority to do so, and if called for, the legal documents in support thereof must be produced for inspection and the same in the case of the firm carried out by one member of a joint family. It must disclose that the firm is duly registered under the India Partnership Act. Any tender signed by a member not holding a power of attorney shall be treated as invalid.
- Tenderer shall note that their tenders shall remain open for acceptance for a minimum period of three months from the last date of receipt of tenders. The tenders must be unconditional. Conditional tenders may be summarily rejected.

• RATES TO INCLUDE:

While quoting their rates the tenderer should include the following if otherwise not stated herein before.

- Necessary cost of taking samples of materials supplied by them for the work, testing of the same at Govt.'s / approved laboratory including transportation, cost of the samples, as and when required.
- Submission of test reports of other materials as may be specified by Bank's Engineer.

• STORAGE OF MATERIALS:

The contractor shall not store their materials and debris within the premises other than the work site handed over to him.

• LABOUR HUTMENT:

Shelter or stay and other amenities for the labors have to be arranged by the contractor at his own expense and responsibility (outside the Bank premises).

• IDLE LABOUR:

In case the work is held up for any site conditions not attributable to the contractors or for any decisions instructions / want of details from Employer or for any of the conditions, the contractor shall be allowed reasonable extension of time by the employer but any claim for idle labour shall not be entertained by the employer. Contractor's quoted rates should include for all such contingencies.

- The contractor shall engage one competent person at site who shall take the instructions from the Employer. The work should not suffer due to lack of supervision, manpower and materials.
- The Contractor is required to co-ordinate his works along with other agencies working at site. He has to reimburse any of the damage made by him or any of his representatives for any of the other agency or owner at site.
- Making of any cut-out / opening for electrical wiring / fitting in any of false ceiling, partition, Paneling, masonry work etc., and providing panels of the same finish in partitions, paneling shall not be paid extra.
- The contractor is required to fabricate a sample where required, or any item so installed for approval. Any changes made by the Architect/Employer, in the sample to the specifications as mentioned in the tender, shall not be deducted or paid extra.
- All measurements given in the schedule hereunder are for the purpose of tender only. Payment will be made on actual measurement of the work done
- All measurements shall be as per relevant I.S. standards

GENERAL CONDITIONS OF CONTRACT

Except where provided for in the description of the individual items in the schedule of quantities and in the specifications and conditions laid down hereinafter and, in the drawings, the work shall be carried out as per standard specifications and under the direction of Employer.

• **INTERPRETATION**

In constructing these conditions, the specifications, the schedule of quantities, tender and agreement, the following words shall have the meaning herein assigned to them except where the subject or context otherwise requires.

Employer: The term employer shall denote **SBI The Regional Manager, State Bank of India, Regional Business Office- II, GODAVARIKHANI , H.NO.5-6-174, First floor, Thirumala Complex, NTPC, Krishna Nagar, Godavarikhani, Peddapalli - 505215)** and any of its employees representative authorized on their behalf.

•**Architects / Consultants:** The term Architects shall mean the Architects appointed by the employer for the purpose of preparing detailed drawing, supervision etc. It is the Bank to decide whether to appoint Architect or not and to change the Architect at any stage of work.

•**Contractor:** The term contractor shall mean _____(Name and address of the contractor) and his / their heirs, legal representatives, assigns & successors.

•**Site:** The site shall mean the site where the works are to be executed, i.e. interior works, Repairing and painting works at SBI Branch including any building and erection thereon, allotted by the employer for the contractors use.

•**Site Engineer:** Any Engineer appointed from time to time by the Employer and certified in writing to the Architects and the Contractor, to be positioned at site to supervise the work.

•**Drawings:** The work is to be carried out in accordance with drawings, specifications, the schedule of quantities and any further drawings which may be supplied or any other instruction, which may be given by the Employer or Architects during the execution of the work.

All drawings relating to work given to the contractor together with a copy of schedule of quantities are to be kept at site and the Employer / Architects shall be given access to such drawings or schedule of quantities wherever necessary.

In case any detailed Drawings are necessary contractor shall prepare such detailed drawings and / or dimensional sketches therefore and have it confirmed by the Employer as case may be prior to taking up such work.

The contractor shall ask in writing for all clarifications on matters occurring anywhere in drawings, specifications and schedule of quantities or to additional instructions at least 10 days ahead from the time when it is required for implementation so that the Employer may be able to give decision thereon.

- **“The Works”** shall mean the work or works to be executed or done under this contract.
- **“Act of Insolvency”** shall mean any act as such as defined by the Presidency MAINs Insolvency Act or in Provincial Insolvency act or any amending status.
- **“The Schedule of Quantities”** shall mean the schedule of quantities as specified and forming part of this contract.
- **“Priced Schedule of Quantities”** shall mean the schedule of quantities duly priced with the accepted quoted rates of the contractor.
- **“Contract”** shall mean the Articles of Agreement, the general conditions special conditions, the appendix, the schedule of quantities, specifications and drawings attached here to and duly signed.
- **‘Contract Price’** shall mean the sum named in the Tender subject to such additions thereto or deductions there from as may be made under the provisions hereafter contained.
- **‘Notice in Writing’** or written notice shall mean a notice in writing, type or printed characters sent (unless delivered personally or otherwise provided to have been received) by registered post to the last known private or business

address or registered office of the addressee and shall be deemed to have been received when in the ordinary course of post it would have been delivered.

- 'Net Prices' any arriving at the Contract amount the Contractor shall have added to or deducted from the total of the items if the Tender any sum, either as a percentage or otherwise, then the net price of any item in the tender shall be the sum arrived at by adding to or deducting from the actual figure appearing in the tender as the price of that item a similar percentage or proportionate sum. Providing always that in determining the percentage or proportion of the sum so added or deducted by the contractor, the total amount of any Prime Cost items and provisional sums of money shall be deducted from the total amount of the Tender. The expression 'net rates' or 'net prices' when used with reference to the contract or account shall be hold to mean rates or prices so arrived at.
- 'Virtual Completion' shall mean the premise is in the opinion of the Employer fit for occupation.
- Words importing persons include firms and corporations. Words importing the singular only, also include the plural and vice verse where the Context requires.

- **SCOPE OF WORK/ CONTRACT**

The Brief Scope of work involves the following.

- Interior Works.
- False Ceiling
- Wall paneling and glass works

The Contractor shall carry out and complete the said work in every respect in accordance with this Contract and with the directions of and to the satisfaction of the Employer. The Architect with approval of Employer or Employer issue further drawings and/or written instructions, detailed directions and explanations which hereafter collectively referred to as 'Instructions' in regard to:

- The variation or modification of the design quality or quantity of works or the addition or omission or substitution of any work.
- Any discrepancy in the drawings or between the schedule of quantities and / or drawings and / or specification.
- The removal from the site of any defective material brought thereon by the contractor and the substitution of any other material thereof.
- The demolition removal and / or re-execution of any work executed by the contractor/s.
- The dismissal from the work of any persons employed there upon.
- The opening up for inspection of any work covered up.
- The rectification and making good of any defects under clauses hereinafter mentioned and those arising during the maintenance period (Defect Liability Period).

The contractor shall forthwith comply with and duly execute any work comprised in such Employer's or his agent / Architect's instructions, provided always that verbal instructions, directions and explanations

given to the contractor's or his representative upon the works by the Employer's or his agent / Architects shall, if involving a variation, be confirmed in writing to the contractor/s within seven days. No works, for which rates are not specifically mentioned in the priced schedule of quantities, shall be taken up without written permission of the Employer. The employer as provided in clause "variation" shall fix rates of items not mentioned in the priced schedule of quantities.

Regarding all factory-made products for which ISI marked products are available, only products bearing ISI marking shall be used in the work.

- **TENDERER SHALL VISIT THE SITE**

Intending tenderer shall visit the site and make himself thoroughly acquainted with the local site condition, nature and requirements of the works, facilities of transport conditions, effective labour and materials, access and storage for materials and removal of rubbish. The tenderer shall provide in their tender for cost of carriage, freight and other charges as also for any special difficulties and including police restriction for transport etc., for proper execution of work as indicated in the drawings. The successful tenderer will not be entitled to any claim of compensation for difficulties faced or losses incurred on account of any site condition. Work to be done in phase manner.

- **TENDERS**

The Employer reserves the right to reject the lowest or any tender.

The tenderers should note that the tender is strictly on the item rate basis and their attention is drawn to the fact that the rates for each and every item should be correct, workable and self-supporting. If called upon by the Employer/Architects detailed analysis of any or all the rates shall be submitted. The Employer/Architects shall not be bound to recognize the contractor's analysis.

The works will be paid for as "measured work" on the basis of actual work done and not as "lump sum" contract, unless otherwise specified.

All items of work described in the schedule of quantities are to be deemed and paid as complete works in all respects and details including preparatory and finishing works involved, directly related to and reasonably detectable from the drawings, specifications and schedule of quantities and no further extra charges will be allowed in this connection. In the case of lump-sum charges in the tender in respect of any items of work will be made for the actual work done on the basis of lump sum charges as will be assessed to be payable by the Employer / Architects.

The employer has power to add, omit from any work as shown in drawings or described in specifications or include in schedule of quantities and intimate the same in writing but no addition, omission or variation shall be made by the contractor without authorization from the Employer. No variation shall vitiate the contract.

The tenderer shall note that his tender shall remain open for consideration for a period of three months from the date of opening of the tender.

- **AGREEMENT**

The successful contractor will be required to sign agreement in accordance with the draft agreement enclosed and the schedule conditions. The contractor shall pay for all stamps and legal expenses, incidental thereto. However the written acceptance by the employer of a tender will constitute a binding contract between the employer and the person so tendering such formal agreement is subsequently executed.

- **AUTHORITIES, NOTICES, PATENT RIGHTS AND ROYALTIES:**

The contractor shall conform to the provisions of any Acts of the Legislature relating to the work, and to the Regulations and Bye-Laws of any authorities, and / or any water, lighting and other companies, and / or authorities with whose systems the structures were proposed to have connection and shall before

making any variations from the drawings or specifications that may be associated to so conform, give the Employer / Architects written notices specifying the variations proposed to be made and reasons for making them and apply for instruction thereon. The Employer / Architects on receipt of such intimation shall give a decision within a reasonable time.

The contractor/s shall arrange to give all notices required for by the said Acts, Regulations or Bye-laws to be given to any authority, and to pay to such authority or to any public officer all fees that may be properly chargeable in respect of the work and lodge the receipts with the Employer The Contractor shall identify the Employer against all claims in respect of patent rights, designs, trademarks or name or the protected rights in respect of any constructional plant, machine, work or material used for or in connection with the works or temporary works and from and against all claims, demands, proceedings, damages, costs, charges, and expenses whatsoever in respect thereof or in relation thereto. The Contractor shall defend all actions arising from such claims, unless he has informed the Employer/ Architects, before any such infringement and received their permission to proceed and shall himself pay all royalties, license fees, damages, coat and charges of all and every sort that may be legally incurred in respect thereof.

- **TAXES AND DUTIES**

The tenderers must include in their tender prices quoted for all taxes(except GST) and duties royalties, cess, local charges if applicable. No extra claim on this account will in any case be entertained.

- **NOTICES AND STATUTORY REGULATIONS:**

The contractor shall give all notices and pay all fees and shall comply all Acts and Regulations for the successful completion of the contract works.

The whole of the work is to be complied with as per the requirements and bylaws of the relevant statutory authorities including contract labor (Regulation and Abolition) Act 1970.

- **QUANTITY OF WORK TO BE EXECUTED**

The Schedule of Quantities unless otherwise stated shall be deemed to have been prepared in accordance with the Standard Procedure shall be considered to be approximate and no liability shall attach to the employer for any error may be discovered therein. The Employer reserves the right to execute only a part or the whole or any excess thereof without assigning any reason therefore.

The Contractor shall be deemed to have satisfied himself before tendering to the correctness and sufficiency of his tender for the works and of the prices stated in the Schedule of Quantities and / or the Schedule of Rates and Prices, which rates and prices shall cover all things necessary for the completion of the works.

- **OTHER PERSONS ENGAGED BY THE EMPLOYER**

The Employer reserves the right to execute any part of the work included in this contract or any work, which is not included in this contract by the other Agency, or persons and contractor shall allow all reasonable facilities and use of his scaffoldings for the execution of such work. The main contractor shall extend all cooperation in his regard.

- **Tenderer should deposit EMD as mentioned in the NIT.**

- **CONTRACTOR TO PROVIDE EVERYTHING NECESSARY**

The Contractor shall provide everything necessary for the proper execution of the work according to the intent and meaning of the drawings, schedule of quantities and specifications taken together whether the same may or may not be particularly shown or described therein provide that the same can reasonably be

inferred there from and if the contractor finds any discrepancies therein he shall immediately and in writing, refer the same to the Employer / Architects whose decision shall be final and binding.

- **TIME OF COMPLETION, EXTENSION OF TIME & PROGRESS CHART**

The Contractor shall be allowed admittance to the site on the 'Date of Commencement' stated in the Appendix, and he shall thereupon and forthwith begin the works and shall regularly proceed with to complete the same. On or before the 'Day of Completion' stated in the Appendix subject nevertheless the provision for the extension of time hereinafter contained.

If in the opinion of the Employer/Architect the works be delayed:

- By force major or
- By reason of any exceptionally inclement weather or
- By reason of proceedings taken or threatened by or dispute with adjoining or neighboring owners of public authorities arising, than through the Contractor's won default or
- By the works or delays of the contractors tradesmen engaged or nominated by the Employer / Architect and not referred in the Schedule of Quantities and / or specifications or
- By reason of civil, commotion, local combination of workmen or strike or lock-out effecting any of the buildings traders or
- In consequence of the Contractor not having in due time, necessary instructions from the Employer for which he shall have specifically applied in writing ahead of time, giving reasonable time to prepare such instructions, the employer shall make a fair and reasonable extension of time for completion of the Contract works

In case of such strike or lock-out, the Contractor shall as soon as possible give written notice thereof to the employer, but the Contractor shall nevertheless constantly use his endeavors to prevent delay and shall do all they may reasonably be required, to the satisfaction of the employer to proceed with the work.

The Contractor on starting the works shall furnish to the Employer / Architect a PERT / CPM Program for carrying out the work stage in the stipulated time for the approval of Architect / Employer and follow strictly the approved time schedule incorporating charges if any, to ensure the completion of the work in stipulated time. A graph or chart on individual work shall be maintained showing the proportionate progress of work week by week a weekly progress report stating the number of skilled and unskilled laborers employed on the work, working hours done, place, type, and quantity of work done during the period.

The Contractor must inform the employer within 10 days in advance of all drawings and detailed required by him from time to time. The Contractor shall adhere to the approved program and arrange for the materials and labour etc accordingly.

Despite repeated instructions, if the Contractor fails to show proportionate progress of the work, the Architect / Employer may take suitable action and deemed fit without prejudice to any terms and conditions of the contract

- **LIQUIDATED DAMAGES**

Should the work be not completed to the satisfaction of the Employer /Architects within the stipulated period, the contractor shall be bound to pay to the Employer a sum calculated as given below by way of liquidated damages and not as penalty during which the work remains un-commenced or unfinished after the expiry of the completion date.

If the contractor fails to complete the work by the Scheduled date of completion or within any sanctioned extended time, he will have to pay liquidated damages at 0.5% of contract amount for each week beyond the date that the work remains incomplete subject to maximum of 5% of the contract value

- **MATERIALS, WORKMANSHIP, SAMPLES, TESTING OF MATERIALS.**

All the works specified and provided for in the specifications or which may be required to be done in order to perform and complete any part thereof shall be executed in the best and most workmanlike manner with materials of the best and approved quality of the respective kinds in accordance with the particulars contained in and implied by the specifications and as represented by the drawings or according to such other additional particulars, and instructions as may from time to time be given by the Employer / Architects during the execution of the work and to his entire satisfaction.

All mandatory tests shall be carried out as per CPWD specifications. If required by the Employer / Architects, the contractor shall have to carry out tests on materials and workmanship in approved materials testing laboratories or as prescribed by the Employer / Architects at his own cost to prove that the materials etc., under test conform to the relevant I.S Standards or as specified in the specifications. The necessary charges, transporting, testing etc., shall have to be borne by the contractor. No extra payment on this account should in any case be entertained.

All the materials (except where otherwise described) stores and equipment required for the full performance of the work under the contract must be provided through normal channels and must include charges for import duties, and other charges and must be the best of their kind available and the contractors must be entirely responsible for the proper and efficient carrying out of the work. The work must be done in the best workmanlike manner. **Samples of all materials to be used must be submitted to the Employer when so directed by the Engineer and written approval from Employer must be obtain prior to placement of order.**

Any damage (during the work) to any part of the work or to the premises for any reasons due to rain, storm or neglect of contractor shall be rectified by the contractor in an approved manner at no extra cost. Should the work be suspended by reason of rain, strike, lock-outs or any other cause, the contractor shall take all precautions necessary for the protection of work and at his own expenses shall make good any damage arising from any of these causes.

The contractor shall cover up and protect from damage, from any cause, all new work and supply all temporary doors, protection to windows, and any other requisite protection for the execution of the work whether by himself or special tradesmen or sub-contractor and any damage caused must be made good by the contractor at his own expenses.

Contractor should take all precaution to safeguard the flooring and if any damages to the flooring should be rectified by the contractor in the same quality at his own cost.

- **REMOVAL OF IMPROPER WORK**

The Employer shall during the progress of the work have power to order in writing from time to time the removal from the work within such reasonable time or times as may be specified in the order of any materials which in the opinion of the Employer / Architects are not in accordance with specification or instructions, the substitution or proper re-execution of any work executed with materials or workmanship not in accordance with the drawings and specifications or instructions. In case the contractor refuses to comply with the order the Employer shall have the power to employ and pay other agencies to carry out the work and all expenses consequent thereon or incidental thereto as certified by the Employer / Architects shall be borne by the contractor or may be deducted from any money due to or that may become due to the

contractor. No certificate, shall relieve the contractor from his liability in respect of unsound work or bad materials.

- **SITE ENGINEER**

The Employer may appoint a Site Engineer or clerk of works who shall be representative of the Employer. The duties of the Employer representative are to watch and supervise the works and to test any materials to be used of workmanship employed in connection with the works. He shall have no authority either to relieve the Contractor of any of his duties or obligations under the Contract, or except those expressly provided hereunder, to order any work involving delay or any extra payment by the Employer or any variation of or in the works.

The contractor shall afford the Employer's representative every facility and assistance for examining the works and materials and checking the measuring time and materials. Neither the Employer's representative nor any assistant to the Architect shall have power to revoke, alter enlarge or relax the requirements of this Contract, or to Sanction any day-work, additions, alterations, deviations or omissions unless such an authority may be specially conferred by a written order of the Employer.

The Employer's Representative shall have to give notice to the Contractor or his foremen about the non-approval of any work or materials and such works shall be suspended or the use of such material should be discontinued until the decision of the employer/Architect is obtained, the work will from time to time be examined by the Architect or the Employer's representative but such examinations shall not in any way exonerate the Contractor from the obligation to remedy defects which may be found to exist at any stage of the work of after the same is completed. Subject to the limitations of this cause, the Contractor shall take instruction from the Architect / Employer.

- **CONTRACTOR'S EMPLOYEES**

The Contractor shall employ technically qualified and competent supervisors for the work who shall be available (by turn) throughout the working hours to receive and comply with instructions of the Employer / Architects. The contractor shall engage at least one experienced Engineer as site-in-charge for execution of the work. The contractor shall employ in connection with the work persons having the appropriate skill or ability to perform their job efficiently.

The contractor shall not employ labour below the age of sixteen years and who is not an Indian National. Any laborer supplied by the contractor to be engaged on the work on day work basis either wholly or partly under the direct order or control of the Employer or his representative shall be deemed to be a person employed by the contractor.

LOCAL LAWS, ACTS, REGULATIONS

The contractor should abide by the central labour regulation and also shall strictly adhere to all prevailing labour laws inclusive of contract labour (Regulation and abolition act of 1970) and other safety regulations. The agency shall comply with the provision of all labour legislation including the latest requirements of all the acts, laws, any other regulations that are applicable to the execution of the tests.

- Minimum wages act, 1948 (Amended)
- Payment of wages act, 1936 (Amended)
- Workmen's compensation act 1923 (Amended)
- Contract labour Regulation and Abolition act 1970 and Central rules 1971 (Amended)
- Chief Labour Commissioner(C) , Ministry of Labour & Employment vide Gazette notification No.F.No.1/13(3)/2017-LS-II dated 20th April 2017 on minimum wages

- Apprentice act 1961 (Amended)
- Industrial employment (Standing order) Act 1946 (Amended)
- Personal injuries (compensation insurance) Act 1963 and other modifications
- Employees' Provident Fund and Miscellaneous Provisions Act 1952 and amendment thereof
- Shop and Establishment Act
- Employer's Liability Act.
- Any other Act or enactment thereof and rules framed there under from time to time. . .

The contractor shall keep the Employer saved harmless and indemnified against claims if any of the workmen and all costs and expenses as may be incurred by the Employer in connection with any claim that may be made by any workmen.

The contractor shall comply at his own cost with the order for requirement of any Health Officer of the State or any local authority or of the Employer regarding the maintenance of proper environmental sanitation of the area where the contractor's laborers are housed or accommodated, for the prevention of small pox, cholera, plague, typhoid, malaria and other contagious diseases. The contractor shall provide, maintain and keep in good sanitary condition adequate sanitary accommodation and provide facilities for pure drinking water at all times for the use of men engaged on the works and shall remove and clear away the same on completion of the works. Adequate precautions shall be taken by the contractor to prevent nuisance of any kind on the works or the lands adjoining the same.

The contractor shall arrange to provide first aid treatment to the laborers engaged on the works. He shall within 24 hours of the occurrence of any accident at or about the site or in connection with execution of the works report such accident to the Employer and also to the competent Authority where such report is required by law.

- **DISMISSAL OF WORKMEN**

The contractor shall on the request of the Employer immediately dismiss from works any person employed thereon by him, who in the opinion of the Employer be unsuitable or incompetent or who may misconduct him. Such discharges shall not be the basis of any claim for compensation or damages against the Employer or any of their officer or employee.

- **ASSIGNMENT**

The whole of the works included in the contract shall be executed by the contractor and the contractor shall not directly or indirectly transfer, assign or underlet the contract or any part, share or interest therein nor, shall take a new partner, without written consent of the Employer and no subletting shall relieve the contractor from the full and entire responsibility of the contract or from active superintendence of the work during their progress

- **INSURANCE & DAMAGE TO PERSONS AND PROPERTY ETC.**

The contractors under the terms of the contract are required to keep the works duly insured under CAR Policy (Contractor All Risk Policy) as well as third Party Insurance for the value of 110% of the Project value or Tender value until the Completion of the project or handing over whichever is later. The insurance policies should be taken in the joint names by the contractors and the same should be renewed at appropriate time.

The contractor shall be responsible for all injury to the work or workmen to persons, animals or things and for all damages to the structural and / or decorative part of property which may arise from the operations or neglect of himself or of any sub-contractor or of any of his or a sub-contractor's employees, whether such injury or damage arise from carelessness, accident or any other cause whatsoever in any way connected with the carrying out of this contract. The clause shall be held to include inter-alia, any damage to buildings whether immediately adjacent or otherwise, and any damage to roads, streets, foot paths or ways as well as damages caused to the buildings and the works forming the subject of this contract by rain, wind or other inclemency of the weather. The contractor shall indemnify the Employer and hold harmless in respect of all and any expenses arising from any such injury or damages to the person or property as aforesaid and also in respect of any claim made in respect of injury or damage under any acts on compensation or damage consequent upon such claim. The contractor shall reinstate all damages of every sort mentioned in this clause so as to deliver the whole of the contract works complete and perfect in every respect and so as to make good or otherwise satisfy all claims for damages to the property of third parties.

The contractor shall affect the insurance necessary and indemnify the Employer entirely from all responsibility in this respect. must be effected jointly in the name of the Employer and contractor and the policy lodged with the Employer. The scope of insurance is to include damage or loss to the contract itself till this is made over in a complete state. Insurance is compulsory and must be affected from the very initial stage. The contractor shall be responsible for anything, which may be excluded from damage to any property arising out of incidents, negligence or defective carrying out of this contract. The Employer shall be at liberty and is hereby empowered to deduct the amount of any damages, compensations, costs, charges and expenses arising or accruing from or in respect of any such claim or damages from any sums due to or to become due to the contractor.

- **MEASUREMENTS**

Before taking any measurement of any work the Site Engineer or employer's representative shall give reasonable notice to the contractor. If the contractor fails to attend at the measurements after such notice or fails to countersign or to record the difference within a week from the date of measurement in the manner required by Site Engineer or by the subordinate deputed by him as the case may be is final and binding on the contractor and contractor shall have no right to dispute the same.

The Employer / Architect shall issue a certificate after due scrutiny of the contractor's bill stating the amount due to the contractor from the Employer and the contractor shall be entitled to payment thereof, within the period of honoring certificates named in these documents.

- **PAYMENTS**

All bills shall be prepared by the contractor in the form prescribed by the Employer's / Architects. Normally one interim bill shall be prepared each month subject to minimum value as stated in these documents.

The bills in proper forms must be duly accompanied by detailed measurements in M-book in support of the qualities of work done and must show deductions for all previous payments, retention money, etc. The Architect shall issue a certificate after due scrutiny of the contractor's bill stating the amount due to the contractor from the Employer and the contractor shall be entitled to payment thereof, within the period of honoring certificates named in these documents.

The Employer will deduct IT, other applicable taxes if any (but GST is reimbursable) and retention money as described in this document. The refund of retention money will be made as specified.

If the Employer has supplied any materials or goods to the contractor, the cost of any such materials or goods will be progressively deducted from the amount due to the contractor in accordance with the quantities consumed in the work.

All the interim payments shall be regarded as payments by way of advance against the final payment only and not as payments for work actually done and completed, and shall not preclude the requiring of bad,

unsound, and imperfect or unskilled work to be removal and taken away and reconstructed, or re-erected or be considered as an admission of the due performance of the contract, or any part thereof in any respect or the accruing of any claim, nor shall, it conclude, determine or affect in any way the power of the Employer under these conditions or any of them as to the final settlement and adjustment of the accounts or otherwise or in any other way vary or affect the contract. The final bill shall be submitted by the contractor within one week of the date fixed for completion of the work or of the date of certificate of completion and payment shall be made within one month from the date of receipt of the bill.

Final Payment

The final bill shall be accompanied by a certificate of completion from the Architects. Payments of final bill shall be made after deduction of Retention Money as specified, which shall be refunded after the completion of the Defects Liability Period after receiving the Branch Manager/Engineer's certificate that the contractor has rectified all defects to the satisfaction of the Employer. The acceptance of the payment of the final bill by the contractor would indicate that he has no further claim in respect of the work executed.

- **VARIATION/ DEVIATION**

The tender rates shall be fixed and applicable for any increase or decrease in the tendered quantities. The Employer / Architect can increase or decrease any quantities to any extent or even delete particular item as per the site requirements and the contractor shall not be paid anything extra on this account. Nothing extra will be paid by the Bank on account of omission / deletion of items or decrease in the quantity of items. The Bank shall not entertain any claim whatsoever from the contractor on this account.

The price of all additional items/non-tendered items will be worked out on the basis of rates quoted for similar items in the contract wherever existing. If similar items are not available, the rates for such items will be derived as per standard method of rate analysis based on prevalent fair price of labour, material and other components as required with 15% towards contractor's profit and overheads.

- **SUBSTITUTION**

Should be contractor desire to substitute any materials and workmanship, he/they must obtain the approval of the Employer/ Architects in writing for any such substitution well in advance. Materials designated in this specification indefinitely by such term as "Equal" or "Other approved" etc. specific approval of the Employer / Architect has to be obtained in writing.

- **CLEARING SITE ON COMPLETION**

On completion of the works the contractor shall clear away and remove from the site all machinery, surplus materials, rubbish and temporary works of every kind and leave the whole of the site and the works clean and in a workmanlike condition to the satisfaction of the Employer/Architects.

- **DEFECTS AFTER COMPLETION**

The contractor shall make good at his own cost and to the satisfaction of the Employer all defects, which may appear within 12 months after completion of the work. In the default, the Employer may employ and pay other persons to amend and make good such damages, losses and expenses consequent thereon or incidental thereto shall be made good and borne by the contractor and such damages, loss and expenses shall be recoverable from him by the Employer or may be deducted by the employer, in lieu of such amending and making good by the contractor, deduct from any money due to the contractor a sum equivalent to the cost of amending such work and in the event of the amount retained being insufficient recover that balance from the contractor from the amount retained (retention money) together with any expenses the Employer may have incurred in connection therewith.

- **CONCEALED WORK**

The contractor shall give due notice to the Employer/Architects whenever any work is to be covered up or finished up or otherwise becoming inaccessible later on, in order that the work may be inspected and correct dimensions taken before such covering, in default whereof the same shall, at the opinion of the Employer/ Architect be either opened up for measurement at the contractor's expenses or no payment may be made for such materials. Should any dispute or differences arise after the execution of any work as to measurements etc., or other matters which cannot be conveniently tested or checked, the notes of the Employer / Architects shall be accepted as correct and binding on the contractor.

- **IDLE LABOUR**

Whatever the reasons may be, no claim for idle labor, additional establishment cost of hire and labor charges of tools and plants would be entertained under any circumstances.

- **SUSPENSION OF WORKS**

If the contractor except on account of any legal restraint upon the Employer preventing the continuance of the work or in the opinion of the Employer shall neglect or fail to proceed with due diligence in the performance of his part of the contract or if he shall more than once make default, the Employer shall have the power to give notice in writing to the contractor requiring the work to be proceeded within a reasonable manner and with reasonable dispatch, such notice purport to be a notice under this clause. After such notice shall have been given, the contractor shall not be at liberty to remove from the site of the works or from any ground contiguous thereto any plant or materials to subsist from the date of such notice being given until the notice shall have been complied with. If the contractor fails to start the work within seven days after such notice has been given to proceed with the works as therein prescribed, the employer may proceed as provided in clause 31 (Termination of Contract by Employer)

- **TERMINATION OF CONTRACT BY EMPLOYER**

If the contractor being a company go into liquidation whether voluntary or compulsory or being a firm shall be dissolved or being an individual shall be adjudicated insolvent or shall make an assignment or a composition for the benefit of the greater part, in number or amount of his creditors or shall enter into a Deed or arrangement with his creditors, or if the Official Assignee in insolvency, or the Receiver of the contractor in insolvency, shall repudiate the contract, or if a receiver of the contractor's firm appointed by the court shall be unable within fourteen days after notice to him requiring him to do so, to show to the reasonable satisfaction of the employer that he is able to carry out and fulfill the contract, and if so required by the employer to give reasonable security therefore, or if the contractor shall suffer execution to be issued, or shall suffer any payment under this contract to be attached by or on behalf of and of the creditors of the contractor, or shall assign, charge or encumber this contract or any payments due or which may become due to contractor, there under, or shall neglect or fail to observe and perform all or any of the acts matters of things by this contract, to be observed and performed by the contractor within three clear days after the notice shall have been given to the contractor in manner hereinafter mentioned requiring the contractor to observe or perform the same or shall use improper materials of workmanship in carrying on the works, or shall in the opinion of the employer not exercise such due diligence and make such progress as would enable the work to be completed within due time agreed upon, and shall fail to proceed to the satisfaction of the employer after three clear das notice requiring the contractor so to do shall have been given to the contractor as hereinafter mentioned or shall abandon the contract, then and in any of the said cases, the Bank may notwithstanding previous waiver determine the contract by a notice in writing to the

effect as hereinafter mentioned, but without thereby effecting the powers of the employer of the obligations and liabilities of the contractor the whole of which shall continue in force as fully as if the contract, had not been so determine and as if the works subsequently executed by or on behalf of the contractor (without thereby creating any trust in favor of the contractor) further the employer or his agent, or servants, may enter upon and take possession of the work and all plants tools scaffolding sheds machinery, steam, and other power, utensils and materials lying upon premises or the adjoining lands or roads and sell the same as his own property or may employ the same by means of his own servants and workmen in carrying on and completing the works or by employing any other contractors or other persons or person to complete the works, and the contractor shall not in any way interrupt or do any act, matter or thing to prevent or hinder such other contractors or other persons or person employed from completing and finishing or using the materials and plants for the works when the works shall be completed, or as soon thereafter as conveniently may be the employer shall give notice in writing to the contractor to remove his surplus materials and plants and should the contractor to remove his surplus materials after receipt by him the employer may sell the same by Public Auction and shall give credit to the contractor for the amount so realized. Any expenses or losses incurred by the contractor for the amount so realized. Any expenses or losses incurred by the employer in getting the amount payable to the contractor by way of selling his tools and plants or due on account of work carried out by the contractor prior to engaging other contractors or against the Security Deposit.

ARBITRATION

All disputes or differences of any kind whatsoever which shall at any time arise between the parties hereto touching or concerning the works or the execution or maintenance thereof this contract or effect thereof or to the rights or liabilities of the parties or arising out of or in relation thereto whether during or after determination foreclosure or breach of the contract (other than those in respect of which the decision of any person is by the contract expressed to be final and binding) shall after written notice by either party to the contract to the other of them and to the Employer hereinafter mentioned be referred for adjudication to a sole Arbitrator to be appointed as hereinafter provided.

For the purpose of appointing the sole Arbitrator referred to above, the Employer will send within thirty days of receipt of the notice, to the contractor a panel of three names of persons who shall be presently unconnected with the organization for which the work is executed from the following categories of Arbitrators”:-

- Retired High Court/Supreme Court judge who have experienced in handling Arbitration Cases.
- Member of Council of Arbitrators
- Fellow of the Institution of Engineers
- Eminent Retired Chief Engineer from State/Central PWD/Public sector undertaking of good reputation and integrity
- Fellow of Indian Institute of Architects

The contractor shall on receipt of the names as aforesaid, select any one of the person's name to be appointed as a sole Arbitrator and communicate his name to the Employer within thirty days of receipt of the names. The Employer shall thereupon without any delay appoint the said person as the Sole Arbitrator. If the contractor fails to communicate such selection as provided above within the period specified, the Competent Authority shall make the selection and appoint the selected person as the Sole Arbitrator.

If the Employer fails to send to the contractor the panel of three names as aforesaid within the period specified, the contractor shall send to the Employer a panel of three names of persons who shall all be unconnected with either party. The Employer shall on receipt appoint him as the Sole Arbitrator. If the Employer fails to select the person and appoint him as the Sole Arbitrator within 30 days of receipt of the

panel and inform the contractor accordingly, the contractor shall be entitled to appoint one of the persons from panel as the Sole Arbitrator and communicate his name to the Employer.

If the Arbitrator so appointed is unable or unwilling to act or resigns his appointment or vacates his office due to any reason whatsoever another Sole Arbitrator shall be appointed as aforesaid.

The work under the Contract shall, however, continue during the arbitration proceedings and no payment due or payable to the contractor shall be withheld on account of such proceedings.

The Arbitrator shall be deemed to have entered on the reference on the date he issued notice to both the parties fixing date of the first hearing.

The Arbitrator may from time to time, with the consent of the parties, enlarge the time for making and publishing the award.

The arbitrator shall give a separate award in respect of each dispute or difference referred to him. The Arbitrator shall decide each dispute in accordance with the terms of the contract and give a reasoned award. The venue of arbitration shall be such place as may be fixed by the Arbitrator in his Sole discretion.

The award of the Arbitrator shall be final and binding on the both the parties.

Subject to aforesaid the provisions to the Arbitration Act. 1992 or any statutory modification or re-enactment thereof and the rules made there under, and for the time being in force, shall apply to the arbitration proceeding under this clause.

The Employer and the contractor hereby also agree that arbitration under clause shall be condition precedent to any right to action under the contract with regard to the matters hereby expressly agreed to be so referred to arbitration

SPECIAL CONDITIONS OF CONTRACT

• DRAWINGS AND SPECIFICATIONS

The works shall be carried out to the entire satisfaction of the EMPLOYER and the Architect, in accordance with the signed drawings and specifications and such further drawings and details as may be provided by the Architect/Employer, and in accordance with such written instructions, directions and explanations as may from time to time be given by the Employer/Architect, whose decision as to the sufficiency and quality of the work and materials shall be final and binding upon all parties. If the work shown on any such further drawings or work that may be necessary to comply with any such instructions directions or explanations, be in the opinion of the contractor extraction that comprised in or reasonably to be inferred from the contract he shall before proceedings with such work, give notice in writing to this effect to employer/Architect, and in the event of the employer/Architects agree to the same in writing the contractor shall be entitled to an allowance in respect of such extra work as on authorized extra. If the Architect and the contractor fail to agree as to whether or to there is an extra, then, if the Employer/Architect decided that the contractor is to carry out the said work, the contractor shall do so, and the question whether or not there is any extra, and its amount thereof, shall failing agreement, be settled by Arbitration as hereinafter provided, but such references shall in no way delay the fulfillment of this contract.

No drawings shall be taken as in itself on order for variation unless, in addition to the employer/Architect's signature, it bears express words stating that is intended to be such an order or bears a remark '**VALID FOR EXECUTION**'. No claim for payment for extra work shall be allowed unless the said work shall have been executed under the provisions of clause 6 (Authorities notices, patent right and royalties) or by the Authorities of directions in drawing of the Architect as herein mentioned.

One complete set of the signed drawings and specification and scheduled of quantities shall be furnished by the Architect to the Contractor. The Architect shall furnish within such time, as he may consider reasonable, one copy of any additional drawing, which in his opinion, may be necessary for the execution of any part of work. Such copies shall be kept at the works, and the architect or his representatives shall, at all reasonable time have access to the same and shall be return to the Architect by the contractor before

the issue of the Final certificate. The contract shall remain in the custody of the Architect, and shall be produced by him at his office as and when required by the Employer or by the contractor.

- **INSPECTION OF DRAWINGS**

Before filling in the tender, the contractor will have to check up all drawings/specification and schedule of quantities, and will have to get an immediate clarification from the employer/ Architect on any point that he feels is vague or uncertain. No claim of damages or compensation will be entertained on this account.

- **EXECUTION OF WORK (PRICES TO INCLUDE)**

The whole of the work is described in the contract a (including the schedule of Quantities, the specifications and all drawing pertaining there to) and as advised by Employer / Architect from time to time is to be carried out and completed in all its parts to the entire satisfaction of the Employer /Architect. Any minor details of the work which may not have been definitely referred to in this contract, but which are usual in practice and essential to the work, are deemed to be include in this contract. Rates quoted in the Schedule shall be inclusive of all frights, Royalties, duties, etc., as well as transportation, so as to execute the contractor as per the rules and regulations of Local Bodies, State Government and Government of India.

The rates quoted in the tender should include all charges for:

- Labor, maintenance fixing, carrying, cleaning, making good, hauling, watering etc
- Plant, machinery, scaffolding, framework, English ladders, ropes, nails, spikes, tools, materials and workmanship protection from weather, shuttering, temporary supports, platform and maintenance of the same.
- Covering for the walling and other works during inclement weather or striking or whenever directed as necessary.

The rates quoted by contractor shall include removal of all the existing furniture and other material & dispose them off where ever required including the furniture and material for which the contract has given the pay back offer.

- **SITE SUPERVISION**

The contractor shall appoint at his own cost competent and adequate number of qualified Engineers at site, for (1) joint measurements and preparations of bills, (2) for testing materials at site and outside laboratory, (3) for other general supervision. Their appointment shall be approved by the Employer / Architect. The site Engineers shall not be removed from the site without the written consent of the Employer / Architect.

- **DIMENSIONS**

Figures, dimensions, are in all case to be accepted preferences to scaled sizes. Large-scale details take precedence over small scale drawings. In case of discrepancy, the contractor is to ask for a clarification before proceeding with the work. Accordingly, if any work is executed without prior clarification it is liable to be rejected and shall not be paid for.

- **PROGRAMME OF WORKS**

Contractor shall have to prepare and submit the CPM/PERT charges for employer approval immediately after issue of the work order and display the approved charts in the site office. He shall also make bar charts indicating individual items and during the progress of work he shall update the bar charts showing the proportionate progress of work every week.

He shall strictly adhere to the program of works as per CPM/PERT charts showing the proportionate progress of work.

- **PROCUREMENT OF MATERIALS**

Contractor shall procure all the materials for the work from the open market. Time is the essence of the contract. Acceptance of the completion date by the contractor shall mean that he has taken into consideration the availability of all material of approved make and quality in sufficient quantities at site to enable him to complete the entire work in the stipulated period. Contractor will get sample of all materials approved by the Employer before placing order / purchase / procurement. They shall conform to I.S. codes and or tender specification as applicable.

For all materials the contractor shall quote for the best quality of the materials of best make / source or supply and it will be got approved by Employer before procurement. In case sufficient quantities of approved quality materials from approved source are not available in time, contractor may have to procure the same from neighboring area with longer leads as required and directed at no extra cost. The material will be, however as per relevant I.S code as and wherever applicable.

- **UNFIXED MATERIALS**

When any materials intended for the works shall have been placed at site by the Contractor, such material shall not be removed there from (except for the purposes of being used on the works) without the written authority of the Employer / Architect and when the contractor shall have received payment in respect of any certificate in which the architect shall have stated that he has taken into account to value of such unfixed materials on the works such material shall become the property of the Employer and the contractor shall be liable for any loss or damage to any such materials.

- **CUSTODY AND SECURITY OF MATERIALS**

The contractors shall be responsible for the custody and security of all materials and equipment at site and he will provide full time watchman / watchmen to look after his materials, stores equipments etc.

- **RATES**

Rates quoted by the contractor shall hold good for all the work carried out to any height and depth as shown in detailed drawings and as required and directed by the Architect.

Rates quoted by the contractor shall also hold good for any small work at any place at site.

- **PRICES FOR EXTRAS ETC., ASCERTAINMENT**

The rates of extra items will be ascertained as below

- The rates will be derived from the rates of items already quoted in the original tender for the extra work.

- Where extra work cannot be properly measured or valued, the contractor shall be allowed any work prices at the net rates stated in the tender or the priced schedule of quantities, or if not so stated, then in accordance with the local day work, rates and wages for the district, provided that in either case vouchers specifying the daily time (and if required by the Architect, the workmen's name) and materials employed at or before the end of the week following that in which the work has been executed.

- The measurements and valuations in respect of the extra items of contract shall be completed within the 'period of final measurement' or within three months of the completion of the contract works as defined under clause (Certificate of Virtual Completion)

- **EXTRA ITEMS RATES**

The work or extra items shall be started only after the approval of extra items rates by client / Architect. Rates for additional or extra items work which cannot be derived from the contract item rates shall be calculated on the basis of actual cost plus 15 % for profit and overheads.

- **DRAWINGS AND INSTRUCTIONS**

A set of major drawings along with the contract documents shall be provided to the contractor. For any clarifications or further drawings are required by the contract, during or before the start of construction work, the Contractor shall inform the employer/Architects in writing to provide the same. Working details will be given to the contractor from time to time during the progress of work as and when required. In case of other drawing is required by the contractor he will give a minimum ten days notice to the Employer / Architect.

- **FAILURE BY CONTRACTOR COMPLY WITH ARCHITECT EMPLOYER'S INSTRUCTIONS**

If the contractor after receipt of written notice from the employer/architect requiring compliance with such further drawings and / or instruction, fails within seven days to comply with the same, the Employer / Architect may employ and pay other persons to execute any such work whatsoever as may be necessary to give effect thereto and all cost incurred in connection there with shall be recoverable from the contractors by the Employer as a debit or may be deducted from any money due or which become due to the Contractors.

- **INFORMATION TO BE SUPPLIED BY THE CONTRACTOR**

The contractor shall furnish the Employer / Architect the following:

- Detailed industrial statistics regarding the labor employed by him etc
- The Power of Attorney, name and signature of his authorized representative who will be in charges for the execution of work
- The list of technically qualified persons employed by him for the execution of this work.
- The total quantity and quality of materials used for the works.
- The list of plant and machinery employed for this work.

- **ARCHITECT'S DELAY IN PROGRESS**

The Architect may delay the progress of the works in case of rains or otherwise, without vitiating the contract and grant such extension of time with the approval of the employer for the completion of the contract as he may think proper and sufficient in consequences of such delay, and the contractor, shall not make any claim for compensation or damage in relation thereto.

FORCE MAJEURE

Neither party shall be held responsible by the other for breach of any condition of this agreement attributable to any 'Act of God' Act of state, lockout of control or any other reason, beyond the control of the parties and any breach of clauses arising from much force majeure conditions as aforesaid shall not be regarded as a breach of the provision of this Agreement.

16. INCOME-TAX & GST IT

Income Tax GST IT shall be deducted at source by the client from the contractor' interim and final bill payments as per Statutory Regulations.

17. SITE MEETINGS

A senior representative of the contractor shall attend weekly meetings at works site and in addition meetings as and when arranged by employer / Architect to discuss the progress of the work and sort out problems, if any and ensure that the work is completed in the stipulated time.

18. SCHEDULE OF APPROXIMATE QUANTITIES AND RATE

- The quantities given herein are approximate and they are subjected to alterations omissions, deductions or additions as provided for in the conditions of this contract and do not necessarily show the actual quantities of the work to be done.
- It is to be expressly understood that the measured work is to be taken net (notwithstanding) any custom or practice to the contrary according to the actual quantities when in place and finished according to the drawings or as may be directed from time to time by the employer and the cost calculated by measurements or weight, at the respective prices, without any additional charge for any necessary or contingent works connected there with. The rates quoted are for work in site and complete in every respects.
- If any operation of work, which is specified in the respective items mentioned in the schedule of quantities, is not executed by the contractor then proportionately the rate quoted in the schedule shall be re-fixed.

19. ACTION WHERE THERE IS NO SPECIFICATION

In case of any class of work for which is there is no specification mentioned, the same will be carried out in accordance with the Indian Standards Specifications subject to the approval of the Employer / Architect

- **ACCIDENT AT SITE**

The contractor shall be responsible for the safety of persons employed by him on the works. This shall be without prejudice to the responsibility of the contractor under the Insurance Clause of the general conditions. Contractor shall take all precaution detailed in the safety code attached separately.

- **TYPOGRAPHICAL CLERICAL ERRORS**

The Employer / Architect clarification regarding partially omitted particulars of typographical or Clericals errors shall be final and binding on the contractors.

- **WORK PERFORMED AT CONTRACTOR'S RISK**

The contractor shall take all precautions necessary and shall be responsible for the safety of the work and shall maintain all lights, goods, signs, temporary passages or other protection necessary for the purpose. All works shall be done by the contractor's risk and if any loss or damage shall result from fire or from others cause, the contractor shall promptly repay or replace such loss or damage free from all expenses to the employer.

The contractor shall be responsible for any loss or damage to materials, tools or other articles used held for use in connection with the work. The work shall be carried on to completion without interferences with the operations of existing machinery or equipment, if any.

- **SPECIAL CONDITIONS OF CONTRACT**

In the event of any discrepancy with clauses mentioned anywhere else in the tender with the clauses mentioned within special conditions of contract, the clauses mentioned within the special conditions of contract shall supersede those mentioned elsewhere.

- **CONTRACTOR'S LABOUR REGULATIONS**

Short title:

- These regulations may be called the "contractor labour regulations."
- **Definitions :-** in these regulations, unless otherwise expressed or indicated, the works and expressions shall have the meaning hereby assigned to them respectively, that is to say :
 - "Labour" means worker employed by the bank's contractor directly or indirectly through a sub-contractor or other persons or by an agent on his behalf of a payment not exceeding Rs. _____/- per month and will not include supervisory staff like overseers etc.
 - "fair wages" means wages whether for time or piece work notified at the time of inviting tenders for the work and where such wages prescribed by the government of India in the ministry of labour and employment vide Sl.No. 1917 published in the gazette of India, extraordinary part - ii section (3) sub-section (ii) dated 19-5-1969.
 - "contractors" shall include every person whether a sub-contractor or headman or agent employing labour on the work taken on contract.
 - "Wages" shall have the same meaning as defined in the payment of wages act and includes time and piece rate wages.
 - a. Normally working hours if an adult employee should not exceed 9 hours a day and in case of a child 4 1/2 hours a day. The working day shall be so arranged that inclusive of interval for rest, if any, it shall not spread over more than 12 hours on any day.
 - When an adult worker is made to work for more than 9 hours on any day or for more than 48 hours in any week, he shall be paid overtime for the extra hours put in by him at double the ordinary rate of wages. Children shall not be made to work extra.
 - Every worker shall be given a paid weekly holiday normally on Sunday in accordance with the provisions of minimum wages (central) rules, 1960 as amended from time to time irrespective of whether such worker is governed by the minimum wages act 1948 or not.

3 Display of notice regarding wage etc. the contractor shall:

- Before the commences his work on contract, display and correctly maintain and continue to display correctly maintain in a clean legible condition in conspicuous places on the work, notice in English and in the local Indian language spoken by the majority of workers, giving the rate of wages which have been certified by the executive engineer, ZONAL labour commissioner fair as wages and the hours of work for which such wages are earned, and
 - Send a copy of such notices to the certifying officer.
 - Payment of wages under central govt. wages act:-
 - Wages due to every worker shall be paid to him direct.
 - All wages shall be paid in current coin or currency or in both.
 - Arrears claimed after 3 months after the completion of the work shall not be entertained.

- Fixation of wage periods:-
 - The contractor shall fix the wage periods in respect of which the wages shall be payable.
 - The minimum daily rates of wages fixed under notification of the government of India in the ministry of labour and employment no. 1972 dated 10-5-78 are inclusive of wages for weekly day of restyle and the question of extra payment for week holiday would not arise.
 - No wage period shall exceed one month.
 - wages of every employed on the contract shall be paid (a) in case of establishments in which wage period is one week within 3 days from the end of the wage period and (b) in the case of other establishments before the expiry of the 7th day or 10th day from the end of the wages period according to the number of workers employed in such establishment does not exceed 1000 or exceeds 1000.
 - When the employment of any worker is terminated by or on behalf of the contractor the wages earned by him shall be paid before the expiry the day exceeding the one on which his employment is terminated.
 - All payment of wages shall be made on a working day except when the work is completed before the expiry of the wage period in which case final payment shall be made within 48 hours of the last working day at work site and during the working time.

Note: The term "working day" means a day on which work on which the labor employed is in progress.

•wage book and wage slips etc. :

the contractor shall maintain a wage book of each worker in such form as may be convenient at the place of work, but the same shall include the following particulars :-

- Name of the worker.
- Rate of daily or monthly wages.
- Nature of work on which employed.
- Total number of days worked during each wage period.
- Dates and periods for which worked overtime.
- Gross wages payable for the work during each wage period.
- All deductions made from the wage with an indication in each case of the ground for which the deduction is made.
- Wages actually paid for each wage period.
- Signature or thumb impression of the worker.
- The contractor shall also issue a wage slip containing the aforesaid particulars to each worker employed by him on the work at least a day prior to the day of disbursement of wages.
- The contractor shall issue the employment card in the prescribed form iii to each worker on the day of work or entry in to his employment. If the worker has already any such card with him from the previous employer, the contractor shall merely endorse that employment card with relevant entries. On termination of employment the employment card shall again be endorsed by the contractor and returned to the worker.

- **The contractor shall issue an attendance-cum-wages card as perform:**

Attached to each worker on the day of each worker on entry into his employment.

- **Register of unpaid wages: -**

The contractor shall maintain a register of unpaid wages in such form as may be convenient at the place of work but the same shall include the following particulars:

- Full particulars of the labourers where wages have not been paid.
- Reference number of the muster roll and wage register.
- Rate of wages.
- Wage period
- Total amount not paid
- Reasons for not making payment
- How the amount of unpaid wages was utilized.
- Acquaintance with dates.

- **Register of accidents:**

The contractor shall maintain a register of accidents in such form as may be convenient at the work place but the same shall include the following particulars:

- Full particulars of the labourers who met with accident.
- Rate of wages.
- Sex
- Age
- Nature of accident and cause of accident.
- Time and date of accident
- Date and time when admitted in hospital
- Date of discharge from the hospital
- Period of treatment and result of treatment.
- Percentage of loss of earning capacity and disability as assessed by the medical officer.
- Claim required to be paid under worker's compensation act.
- Date of payment of compensation.
- Amount paid with details of persons to whom the same was paid.
- Authority by whom the compensation was assessed.
- Remarks.

- **Fines and deductions which may be made from wages:**

- The wages of a worker shall be paid to him without any deduction of any kind except the following:
 - Fines.
 - Deduction for absence from duty i.e. from the place or the places whereby terms of his employment he required to work. The amount of deduction shall be in proportion to the period for which he was absent.

- Deduction for damage to or loss of goods expressly entrusted to the employed person for custody, or loss of money or any other deduction which he is required to account, where such damage or loss is directly attributable to this neglect or default.
- Deduction for recovery of advances or for adjustment of over-payment of wages, advance granted shall be entered in a register.
 - Any other deduction which the central government may from time to time allow.
- No fine should be imposed on any worker save in respect of such acts and omission on his part as have been approved by the chief labour commissioner.
- No fine shall be imposed on a worker and no deduction for damage or loss shall be made from his wages until the worker has been given an opportunity of showing cause against such fines or deductions.
- The total amount of fine which may be imposed in any one wage period on a worker shall not exceed an amount equal to three paise in a rupee of wages, payable to him in respect of that wage period.
- No fine imposed on any worker shall be recovered from him by installment, or after the expiry of sixty days from the date on which it was imposed.
- Every fine shall be deemed to have been imposed on the day of the act or omission in respect of which it was imposed.

- **Register of fines, etc.:**

- The contractor shall maintain a register of fines and a register of deduction for damage or loss in form nos. 1 & 2 respectively which should be kept at the place of work.
- The contractor shall maintain both in English and the local Indian language, a list approved by the chief labour commissioner clearly stating the acts and omissions for which penalty or fine may be imposed on a workman and display it in a good condition in a conspicuous place of the work.

- Preservation of registers –**

the wage book the wage slips, the register of unpaid wages, the register of accidents, the register of fines, deductions required to be maintained under these regulations shall be preserved for 45 days after the date of last entry made in them and shall be made available for inspection by the engineer-in-charge labour welfare officer or any other officer authorized by the chief labour commissioner in this behalf.

- **Powers of labour welfare officer to make investigation or enquiry**

The labour welfare officer or any other person authorized by the central government on their behalf shall have power to make enquiries with a view to ascertaining and enforcing due and proper observance of the fair wage clauses and provisions of these regulations. He shall investigate into any complaint regarding the default made by the contractor or sub-contractor in regard to such provision.

- **Report of labour welfare officer**

The labour welfare officer or other persons authorized as aforesaid shall submit a report of result of his investigation or enquiry to the executive engineer concerned indicating the extent, if any, to which the default has been committed, with a note that necessary deduction from the contractor's bill be made and the wages and other dues be paid to the labourers concerned. In case an appeal is made by the contractor under clause 14 of these regulations actual payment to the labourers will be made by the executive engineer after the zonal labour commissioner has given his decision on such appeal. The executive engineer shall arrange payments to the labours concerned within 45 days from the receipt of the report from the labour welfare officer or the zonal labour commissioner as the case may be. □ The executive

- **Appeal against the decision of labour welfare officer:**

Any person aggrieved by the decision and recommendations of the labour welfare officer or other person so authorized may appeal against such decision to the zonal labour commissioner concern within 30 days from the date of decision, forwarding simultaneously a copy of his appeal to the executive engineer concerned but subject to such appeal, the decision of the officer shall be final and binding upon the contractor.

- **Prohibition regarding representation through lawyer:**

(a) A workman shall be entitled to be represented in any investigation or enquiry under this regulation by:

- An officer of a registered trade union of which he is a member.
- An officer of a federation of trade unions to which the trade union referred to in clause (a) is affiliated.
- Where the employee is not a member of any registered trade union, by any officer, of a registered union, connected with, or by any other workman, employed in the industry in which the worker employed.
- An employer shall be entitled to be represented in any investigation or enquiry under this regulation by;
 - An officer of any association of employers of which he is a member.
 - An officer of a federation of association of employers to which the Association referred to in clause (a) is affiliated.
 - Where the employer is not a member of any association of employers' by an officer of association of employers connected with or by any other employer, engaged in the industry in which the employer is engaged.
 - No party shall be entitled to be represented by a legal practitioner in any investigation or enquiry under these regulations.

- **Inspection of books and slips:**

The contractor shall allow inspection of the wage books and the wage slips the register of unpaid wages, the register of a accident, and the register of fines and deduction to any of his workers or to his agent at a convenient time and place after due notice is received or to the labour welfare officer or any other person authorized by the central government on his behalf.

- **Submission of returns:**

The contractor shall submit periodical returns as may be specified from time to time.

Amendment: the central government may from time to time add to or amend the regulation and on any question as to the application, interpretation or effect of these regulations the decision of the chief labour commission or deputy chief labour commission to the government of India, or any other person authorized by the central government in that behalf shall be final. □

Safety code

□ **Scaffolds:**

- Suitable scaffolds should be provided for workmen for all works that cannot safely be done from the ground, or from solid construction except such short period work as can be done safely from ladders. when a ladder is used an extra mazdoor shall be engaged for holding the ladder and if the ladder used for carrying material as will, suitable footholds and hand holds shall be provided on the ladder and the ladder shall be given an inclination not steeper than 1/4 to 1 (1/4) horizontal and 1 vertical)

- Scaffolding or staging more than 4m. above the ground or floor, swung or suspended from an overhead support or erected with stationary support shall have a guard rail properly attached bolted, braced and otherwise secured at least 3 feet high above the floor or platform of such scaffoldings or staging and extending along the entire length of the outside and ends there of with only such opening as may be necessary for the delivery of materials. Such scaffolding or staging shall be so fastened as to prevent it from swaying from the building or structure.

- Working platform, gangways, and stairways should be so constructed that they should not sag unduly or unequally, and if the height of the platform or the gangway or the stairway is more than 12 feet above the ground level on the floor level. They should be closely boarded, should have adequate width and should be suitably fastened, as described in (ii) above.

e means to prevent the fall of persons or materials by providing suitable fencing or railing whose minimum height shall be -3'0". Wherever there are open excavations in ground, they shall be fenced off by suitable railing and danger signals installed at night so as to prevent persons slipping into the excavations.

□ every opening in the floor of a building or in a working platform be provided with suitabl

- Safe means of access shall be provided to all working platforms and the working places. Every ladder shall be securely fixed. No portable single ladder shall be over 9m. In length while the width between sides rail in rung ladder width shall in no case be less than 290mm. For ladder up to and including 3m. In length. For longer ladders this width should be increased at least 20mm. for each additional meter or length.

- A sketch of the ladders and scaffolds proposed to be used shall be prepared and approval of the engineer obtained prior to construction.

Other safety measures

- All personnel of the contractor working within the plant site shall be provided with safety helmets. All welders shall wear welding goggles while doing welding work and all metal workers shall be provided with safety gloves. Persons employed on metal cutting and grinding shall wear safety glasses.
- Adequate precautions shall be taken to prevent danger from electrical equipment. No materials on any of the sites of work shall be so stacked or placed as to cause danger or inconvenience to any person or the public.

FORM OF AGREEMENT

ARTICLES of AGREEMENT made this _____day of __year 2024 between the **THE REGIONAL MANAGER, SBI GODAVARIKHANI** (Hereinafter referred to as the “Employer/Owner/client” which expression shall, unless excluded by or repugnant to the context, includes its successors and assigns) of the ONE PART and ___of _____(Hereinafter referred to as “Contractor” unless excluded by or repugnant to the context, includes its successors and assigns) of the OTHER PART.

WHEREAS the Employer intends to carry out (**PROPOSED INTERIOR WORKS FOR ADB METPALLY BRANCH , RBO GODAVARIKHANI ,AO NIZAMABAD**)
shall

herein after referred to as “Project”. AND WHEREAS for the purpose of the above said project, the Employer invited sealed tenders from experienced, resourceful and bonafied contractors vide his Notice Inviting Tender (NO.____dated._____).

WHEREAS the contractor submitted his Tender Documents containing Notice Inviting Tender, General notes, General Conditions of Contract, Special conditions, Schedule of approximate quantities and rates , Form of Agreement, General Specification, Approved manufacturers/ natural source of materials, Declaration, Technical Specifications as in Schedule of Quantities etc. for the above said project, (Hereinafter collectively referred to as the “said conditions”), duly signed on each page as a token of his acceptance of the same, along with requisite Cost of tender and Earnest Money Deposit

AND WHEREAS out of the tenders received, the Tender of the contractor was found to be most suitable for the project.

AND WHEREAS the Employer has accordingly issued the work order (NO.____dt.____) to the contractor subject to his furnishing the requisite Security Deposit.

AND WHEREAS the Contractor has accepted the aforesaid Work Order vide his letter of acceptance NO. _____dt._____and has also deposited with the Employer a sum of Rs._____which with the Earnest Money of RS. _____forms the requisite Security Deposit @ 2 % of the accepted Tender Value of Rs.____.

NOW, therefore, it is hereby agreed to and between the parties as follows:

- Contract documents

The following documents shall constitute the Contract Documents.

- This Article of Agreement.
- Tender Document submitted by the Contractor including the “said conditions”, N.I.T and Schedule of quantity.
- All correspondence between the Employer and the Contractor from the date of issue of N.I.T and the date of issue of work order.
- Work order No. _____ dt. _____

•In consideration of the payments to be made to the Contractor as hereinafter provided the Contractor shall upon and subject to the said conditions, execute and complete the contracted project works shown upon the said drawings etc. and such further detailed drawings as may be furnished to the contractor by the said Employer and described in the said Specifications and the said Schedule of Quantities.

•Notwithstanding what are stated in the N.I.T conditions of Tendering, Conditions of Contract of herein stated before, the Employer reserves itself the right of altering the drawings and the nature of the work and addition to or omitting any items of work or of having portions of same carried out departmentally or otherwise and such alterations or variations shall be carried out without prejudice to this contract.

•As mentioned in Article 1 above, the “said conditions” shall be read and be treated as forming part of this agreement and parties hereto will respectively be bound thereby and to abide by and submit themselves to the conditions and stipulations and perform the same on their parts to be respectively observed and preferred.

•Any dispute arising under this agreement shall be referred to the Arbitration in a manner specified in the General Conditions of the Contract and all legal disputes shall be limited within the territorial jurisdiction of the Godavarikhani thereto. The decision of the arbitration shall be final and binding on both the parties.

•IN WITNESS WHEREOF THE PARTIES to their present have here under set and subscribed their hands, the day, month and year first above written.

Signed and delivered for and on behalf of
State Bank of India, Shri. _____ its duly authorized official, In the presence of –

- (Name and Address)
- (Name and Address)

Signed and delivered for and on behalf of
The Contractor _____ by Shri _____ his duly authorized official, in the presence of –

- (Name and Address)
- (Name and Address)

**THE REGIONAL
MANAGER, SBI**

READ, UNDERSTOOD AND ACCEPTED

**SIGNATURE OF THE CONTRACTOR WITH
SEAL DATE**

DECLARATION

**TO
THE REGIONAL MANAGER,
STATE BANK OF INDIA,
RBO - II, GODAVARIKHANI,
FIRST FLOOR, THIRUMALA COMPLEX, NTPC,
KRISHNA NAGAR, GODAVARIKHANI,
DIST: PEDDAPALLI - 505215**

**NAME OF THE WORK: FOR PROPOSED INTERIOR WORKS FOR SBI ADB
METPALLY BRANCH , RBO GODAVARIKHANI ,AO NIZAMABAD**

I/We__ have inspected the site of works and have made me / us fully acquainted with the local conditions in and around the sites of works. I/We hereby declare that I/We have gone through the conditions laid down in the Notice Inviting Tender, Conditions of Contract, Technical Specifications, Bill of Quantities, approved makes and understood the same and on the basis of the same I/We quoted our rates in the Schedule of Quantities attached with the tender documents.

We accept all the terms and conditions of tender documents. We will abide by the technical specification mentioned in the tender. We here by undertake to use only specified material/ make as per the tender schedule.

I undertake to submit a hard copy & scanned copy of the tender duly signed on all pages of the tender at your office.

For any type of deviation (to any of above or subsequent instructions), it will be my/ our responsibility to obtain the written instruction of the Engineer-in-charge for the same failing which it shall be deemed that I have carried out any such deviations at my own and I shall be duty bound to replace the all deviated material/ works from the site at my/ our cost as well as I shall be liable to penalized by the employer as deemed fit and for all such loses made thereof, I/ we shall not have any right to arbitrate in any manner.

I/We shall also uniformly maintain such progress as may be directed by the Employer / Architect to ensure completion of same within the target date as mentioned in the tender document.

Witness:

Signature of Tender Address____

Date: __

LIST OF APPROVED MANUFACTURERS / NATURAL SOURCES OF MATERIALS TO BE USED IN THE INTERIOR WORKS SUBJECT TO THE APPROVAL OF SAMPLES BY SBI / ARCHITECT. (ALL THE MATERIALS USED HAVE TO CONFIRM TO GREEN INTERIOR NORMS OF IGBC)

<u>S. No.</u>	<u>MATERIAL NAME.</u>	<u>BRAND / MANUFACTURER.</u>
1.	PLYWOOD - BWR (Boiling Water Resistant, Termite Resistant & Borer Resistant) - CONFIRMING TO IS: 303.	GOLDENPLY / SARDAPLY / ARCHID / GREENPLY / CENTURY / UNIPLY / RAMA PLY / MAYUR / NATIONAL PLYWOOD.
2.	FLEXI PLYWOOD - BWP (Boiling Water Resistant, Termite Resistant & Borer Resistant) - CONFIRMING TO IS: 303.	GOLDENPLY / SARDAPLY / ARCHID / GREENPLY / CENTURY / UNIPLY / RAMA PLY / NATIONAL PLYWOOD.
3.	BLOCK BOARD - CONFIRMING TO IS :11255 - 2003.	NIKON / GOLDEN / TRUWUD / ARCHID / GREENPLY.
4.	FLUSH DOOR - CONFIRMING TO IS : 2202 (Part - 1) - 1991.	NIKON / GREENPLY / EGG WOOD / RAMA.
5.	LAMINATE - CONFIRMING TO IS : 2046-1995.	GREENLAM / MERINO/ CENTURY / ARCHID / MONARCHLAM / VIR LAMINATE / MIKA.
6.	GLASS.	SAINT GOBAIN / GUJRAT GUARDIAN / TRIVENI / MODIFLOAT / ASAHI FLOAT.
7.	HARDWARE.	EFFICIENT GADGETS / KUBIK / HETTICH / EARL BEHARI (EBCO) / HARDWIN / ETALICA / GODREJ.
8.	BEECH WOOD.	AS APPROVED BY SBI / ARCHITECT.
9.	SCREWS.	GKW NETTLEFOLD OR AS APPROVED.
10.	ADHESIVES.	MOVICOL / FEVICOL SH / ARALDITE.
11.	PAINT.	ASIAN / NIPPON / BERGER / KANSAI NEROLAC.
12.	FLOOR SPRING / DOOR CLOSER.	HETTICH/DOORSET / STERLING / DORMA / OZONE.
13.	LOCKS.	DOORSET / GODREJ/ HETTICH.
14.	GI SUPPORT SYSTEM FOR PLAIN FALSE CEILING.	GYPSTEEL ULTRA / US BORAL.
15.	GI DRY WALL PARTITION SYSTEM.	GYPSTEEL / US BORAL / FRAME WORK / RONDO / BMS.
16.	GYP SUM / PLASTER BOARDS.	GYPBOARD / LAGYP.
17.	GI SUPPORT SYSTEM FOR GRID CEILING.	ARMSTRONG / GYPSTEEL ULTRA / US BORAL.
18.	CEILING TILES.	ARMSTRONG / GYPROCK / US BORAL.
19.	ACRYLIC SOLID SURFACE.	LG Hausys, HI - MACS / DUPONT - MONTELLI / STARON / LOTTE - STARON.
20.	TEXTURED PAINT.	TERRACO / SPECTRUM.
21.	VINYL FLOORING.	LG / WINNER.
22.	MOBILE PEDESTAL UNIT.	GODREJ / FEATHERLITE / MONARCH / METHODEX.
23.	VITRIFIED, CERAMIC AND GLAZED TILES.	JOHNSON / SIMPOLO / KAJARIA / RAK / VARMORA.
24.	SANITARY FAUCETS AND FIXTURES.	JAGUAR / HINDWARE / KOHLER.
25.	ALUMINIUM COMPOSITE PANELS.	ALSTRONG / EUROBOND / ALUDECOR.

26.	CARPET TILES FLOORING.	GODREJ / ELEMENT / UNITEX / FLORTEX.
27.	CEMENT FIBER / CALCIUM SILICATE / REINFORCED MAGNESIUM SILICATE BOARD.	VISAKA / TRILITE / SHERA / BISON.

LIST OF APPROVED MANUFACTURERS / NATURAL SOURCES OF MATERIALS TO BE USED IN THE CIVIL WORKS SUBJECT TO THE APPROVAL OF SAMPLES BY THE SBIIMS / ARCHITECT. (ALL THE MATERIALS USED HAVE TO CONFIRM TO GREEN INTERIOR NORMS OF IGBC)

<u>S.No</u>	<u>MATERIAL NAME.</u>	<u>BRAND / MANUFACTURER.</u>
1.	CEMENT	L&T, BIRLA, ACC
2.	ANTI-TERMITE CHEMICALS	CHLOROPYROPHOS, EMULSIFIABLE CONCENTRATES
3.	BRICKS	GOOD QUALITY BRICKS
4.	UPVC WINDOWS & VENTILATORS	NCL, LG & FENESTA
5.	FPVC DOOR FRAMES & SHUTTERS	NCL, LG & FENESTA
6.	VITRIFIED TILES	JOHNSON, KAJARIA, RAK
7.	PAINTS	ASIAN, NEROLAC, JOTUN
8.	STEEL	TATA, VST, SAIL
9.	SAND	RIVER SAND
10.	FIRE RESISTANT DOORS	SHAKTI MET DOOR, AHLADA
11.	GROUTS & EPOXY	LATECRETE EPOXY, BOSTIK EPOXY
12.	WATER PROOFING	FORSOC, ALGI PROOF
13.	WHITE CEMENT	BIRLA
14.	SINKS	NIRALI
15.	SANITARY FIXTURES	JAGUAR / HINDWARE / KOHLER/CERA.
16.	CP FITTINGS	JAGUAR / HINDWARE / KOHLER/CERA.
17.	CPVC PIPES	ASTRAL, FLOGUARD
18.	PVC PIPES	SUDHAKAR, CLIPSAL
19.	SWG PIPES	INDO
20.	GALVALUME SHEET	APPROVED BY ENGINEER / ARCHITECT
21.	FRP SHEET	APPROVED BY ENGINEER / ARCHITECT
22.	ACP PANEL	APPROVED BY ENGINEER / ARCHITECT

NOTE: The Contractor shall use only above mentioned material. All other materials shall confirm to the specifications laid down. The Contractor shall take this into account while tendering rates / prices. All materials and sections used should adhere to the manufacturer's guidelines and the contractor has to submit certificate from the manufacturer on usage of their specified product / sections.

PRICE BID

PROPOSED INTERIOR WORKS FOR ADB METPALLY BRANCH, RBO GODAVARIKHANI, AO NIZAMABAD, SBI.

<u>S.No.</u>	<u>Item. / Particulars.</u>	<u>Unit.</u>	<u>Quantity</u>	<u>Rate.</u>	<u>Amount.</u>
	INTERIOR WORKS		:		
1	FULL HEIGHT PARTITIONS:	Sq.M.	33		
	Providing and fixing metal stud dry wall partition with following specifications: The Partition will be fully opaque OR partly opaque and partly glazed as per specific site conditions and drawings.				
	(a) Supporting system comprising of 51mm / 50mm x 35mm / 34mm x 0.5mm metal studs at 600mm c/c and 51mm / 50mm x 32mm x 0.5mm metal tracks at floor, door and ceiling level with joints staggered to avoid through joints. The vertical members should touch the ceiling with horizontal ceiling channel at slab / beam bottom. The rate should also include necessary strengthening with studs / tracks or channels at doors and other openings.				
	(b) 12mm MDF Exterior Grade Board fixed on both sides with 25mm dry wall screws for the entire height of the partition.				
	(c) Partition from floor level upto Ceiling / false ceiling level to have 8mm x 100mm 1mm glossy Laminate (silver color) at bottom + from 100mm to 300mm level to have 1mm Glossy Laminate (blue color) + from 300mm level to 1100mm level to have 1mm Glossy Laminate (white color) + from 1100mm level to 1200mm level 1mm Glossy Laminate (blue color) + from 1200mm level to 2100mm level to have 1mm Textured / Glossy / Plain Laminate (white color) + from 2100mm level to 2200mm level 1mm Glossy Laminate (blue color) on both sides as shown in drawing, from 2100mm to ceiling level with Plain white laminate. (In the Branch manager's cabin laminate shades are finalized by Bank's Engineer In-charge.				

	<p>(d) Partition to have 8mm clear float glass fixed with 85mm x 15mm round MDF Exterior Grade jamb and 12mm x 12mm MDF Exterior Grade button beading on both sides of the glass, to a neat finish as per drawings and direction set, complete.</p> <p>(e) Partition above 2200mm level to have 1mm Laminate (White color - Matt finish) / NO VOC or LOW VOC plastic emulsion paint finish on both sides as shown in drawing.</p>				
	<p>(f) All exposed surfaces of MDF Exterior Grade members to have minimum two coats of LOW VOC or NO VOC duco paint finish.</p> <p>(g) All sections used should adhere to the manufacturers guidelines and the contractor has to submit certificate from the manufacturer on usage of their specified sections. Partition measurement will be considered from floor level to false ceiling level.</p>				
2	HALF HEIGHT PARTITIONS:	SQM.	22		
	<p>Same as item Full height partition above, but for height of 1200mm from finished floor level, to a neat finish as per drawings and directions etc., complete and the following:</p> <p>(a) 12mm x 75mm capping of MDF Exterior Grade Board on top with minimum two coats of LOW VOC or NOW VOC duco paint as per drawings and directions etc., complete.</p> <p>(b) Partition from floor level upto 1200mm level on both sides with 1mm glossy Laminate (silver color) at bottom + from 100mm to 300mm level to have 1mm Glossy Laminate (blue color) + from 300mm level to 1100mm level to have 1mm Glossy Laminate (white color) + from 1100mm level to 1200mm level 1mm Glossy Laminate (blue color)</p> <p>(c) The cost to include all materials and hardware required etc., as per site conditions. The rate is for a finished item of work etc., complete as directed.</p>				
3	35MM DOORS IN PARTITIONS:	SQM.	12		

	<p>Providing and fixing 35mm thick solid core flush shutter with 85mm x 18mm MDF Exterior Grade jamb all-round and 12mm x 12mm MDF Exterior Grade button beading fixed 1mm Laminate as specified on both sides and 8mm clear float glass with 3M privacy film fixed as per drawing with 50mm x 18mm MDF Exterior Grade jamb around the glass opening and 12mm x 12mm MDF Exterior Grade beading for fixing of glass on both sides.</p> <p>The rate to include necessary hardware viz., door stopper, door buffer, pair of "H "type handles, Mortise Dead Lock and Euro Profile Cylinder - Key and Knob 70mm SS, 4 Nos. SS 2 ball-bearing hinges-(127mmx76mmx2.5mm),door closer(all of approved make and quality), ZEROVOC or NO VOC duco paint finish for all exposed surfaces of MDF Exterior Grade members, etc., complete as directed.</p>				
4	FIXED GLASS WORKS: 12MM TOUGHENED GLASS WORK	SQM	14		
	<p>Providing, making and fixing in position Fixed 12mmtoughenedglassasfixedglassfromFloorto available Ceiling level. The glass is to be fixed with patch fittings and all the edges of the glass have to be polished for a smooth finish. The work includes cost of all materials, approved hardware, making necessary template before toughening of glass and fixing the same as per site conditions to a neat finished work as per drawings and directions etc., complete.</p>				
5	12MM TOUGHENED GLASS MAIN ENTRANCE DOOR AND PARTITION DOORS:	SQM	6		
	<p>Providing, making and fixing in positionFixed 12mm 10mm toughened glass openable shutters work as per specifications given below and forthe openings mentioned. Main Entrance Glass Work comprising of Door opening of approximate size 1800mm x 2100mm - 2400mm in two pieces, and Partition Doors of approximate size 900 - 1000mm x 2250mm - 2400mm. The entire work to be done aspersiteconditionswithfollowingspecifications etc., complete as directed.</p>				

	<p>(a) Entrance door-Providing, fixing in position glazed entrance Double door / Single door with patch fitting or approved make (Double Door approx. Size: 1800mm - 1500mm x 2400mm - 2250mm and Single Door approx. Size: 900mm - 1200mm x 2400mm - 2250mm) using 12mm toughened glass edge polished. The Door to consist of Heavy Duty Floor spring, Upper Patch, Bottom Patch, Lock Keeper Plate, Euro Profile Cylinder (EPC), "H" Type Handle 32 x 600mm, Corner Lock and the side fixed glass to have 2 Nos. Bottom Patch and 2 Nos. Upper Patch for each door to a neat finish etc.,</p> <p>(b) The work includes cost of all materials, approved hardware, making necessary template before toughening of glass and fixing the same as per site conditions to a neat finished work as per drawings and directions etc., complete.</p>				
6	WALL PANELLING:	SQM.	55		
	Same as item Full height partition , but for Wall Paneling. The basic frame work to comprise all cladding specified only from one side to a neat job as per drawings and directions etc., complete.				
	<p>(a) Providing 18mm thick MDF Exterior Grade jamb for door and window openings of suitable depth as per site conditions.</p> <p>(b) All exposed surfaces of MDF Exterior Grade members to have NO VOC or LOW VOC duco paint finish.</p>				
7	COLUMN PANELLING:	SQM.	22		
	<p>Providing and fixing metal stud column paneling with following specifications:</p> <p>(a) Supporting system comprising of 51mm / 50mm x 35mm / 34mm x 0.5mm metal studs at 600mm c/c and 51mm / 50mm x 32mm x 0.5mm metal tracks at floor, middle, lintel level and ceiling level with joints staggered to avoid through joints. The vertical members should touch the ceiling with horizontal ceiling channel at slab / beam bottom. The rate should also include necessary strengthening with studs / tracks or channels at doors and other openings.</p> <p>(b) 12mm MDF Exterior Grade Board fixed on all four sides with 25mm dry wall screws for the entire height of the partition.</p>				

	<p>(c) Column Paneling from floor level upto Ceiling level to have 100mm Skirting with glossylaminate (silver color) at bottom + from 100mm to Ceiling level to have 1mm Glossy Laminate (Beech Wood color) on two longer sides of the column as shown in drawing.</p> <p>(d) Column Paneling to have 8mm toughened glass with 1mm glossy Laminate in blue color fixed with 12mm x 12mm MDF Exterior Grade button beading on two shorter sides of the column, to neat finish as per drawings and direction setc., complete.</p> <p>(e) All exposed surfaces of MDF Exterior Grade members to have minimum two coats of LOW VOC or NO VOC duco paint finish.</p> <p>(f) All sections used should adhere to the manufacturers guidelines and the contractor has to submit certificate from the manufacturer on usage of their specified sections.</p>				
8	GRID FALSE CEILING:	SQM.	140		
	<p>Providing & Fixing of Mineral Fiber Acoustical Suspended Ceiling System with 15mm Tiles and Exposed GRID. The tiles should have Humidity Resistance (RH) of 90% - 99%, NRC 0.5, Light Reflectance $\geq 87\%$, Thermal Conductivity $k = 0.052$ - 0.057 w/m K, Colour White, Fire Performance UK Class 0 / Class 1 (BS 476 pt - 6 & 7) in module size of 600 x 600 x 16mm, suitable for Green Building application, with Recycled content of 30% - 45%.</p> <p>The tile shall be laid on Microline / Silhouette profile grid system with 15mm - 16mm white flanges incorporating a 6mm central reveal in white/black colour and with a web height of 38mm and a load carrying capacity of minimum 8 Kgs/M² & minimum pull out strength of 100Kgs. Microline / Silhouette, Main Runners & Cross Tees to have mitered ends & "birdsmouth" notches to provide mitered cruciform junctions. The T Sections have a Galvanizing of 90 grams per M² and need to be installed with Suspension system as per manufacturers details.</p>				

	<p>The Installation to comprise main runner spaced at 1200mm centre securely fixed to the structural soffit using US Boral / Gyproc / Armstrong suspension system (specifications below) at 1200mm maximum centre. The First/Last suspension system at the end of each main runner should not be greater than 450mm from the adjacent wall.</p>				
	<p>Flush fitting 1200mm long cross tees to be interlocked between main runners at 600mm centre to form 1200 x 600 mm module. Cut cross tees longer than 600mm require independent support. 600 x 600mm module to be formed by fitting 600mm long flush fitting cross tees centrally between the 1200 mm cross tees. Perimeter trim to be Wall angles of size 3000mm x 19mm x 19mm, secured to walls at 450 mm maximum centre.</p>				
<p>9</p>	<p>PLAIN FALSE CEILING:</p>	<p>SQM.</p>	<p>38</p>		
	<p>Note: (No separate measurements will be considered for the vertical surfaces and cove lighting areas only plan area will be considered for the measurements. For Duct AC, beyond 150mm, vertical surfaces are considered for measurement other than 150mm only, Initial 150mm will not be considered). Providing and fixing Concealed Grid suspended ceiling system of 12.5mm Gypsum Boards / Standard Plaster Boards fixed to ceiling Frame Work as per manufacturers instructions and details for a concealed grid key lock suspended ceiling system consisting of following: Providing and fixing Concealed Grid suspended ceiling system of 12.5mm Gypsum Boards / Standard Plaster Boards fixed to ceiling Frame Work as per manufacturers instructions and details for a concealed grid key lock suspended ceiling system consisting of following:</p>				
	<p>(a) 27x37x1.6mm Soffit Clip, 5mm suspension rod / 25 x 10 x 0.5mm Ceiling Angle, adjustable spring loaded suspension clip / 2.64mm dia Connecting Clip, 20 x 28 x 30 x 0.5mm Perimeter Channel, Top Cross Rail of 3000mm long of 0.55BMT Furring Channel / 15 x 45 x 15 x 0.9mm Intermediate Channel and 4000mm long made of 0.5mm BMT the Top Cross Rail / 80 x 26 x 0.5mm Ceiling Section to be suspended from ceiling at every 1200mm and Furring / Intermediate Channel to be fixed to Top Cross Rail / Ceiling</p>				

	<p>Sectionate every 600mm to make a grid of 1200x 600mm.</p> <p>(b) All sections used should adhere to the manufacturers guidelines and the contractor has to submit certificate from the manufacturer on usage of their specified sections.</p> <p>(c) Further the rates to include cutouts for lighting fixtures / AC grilles / Fire Alarm Detectors etc., along with necessary strengthening and supports for fixing of these. The board joints are to be flush finished with jointing compound and paper tape etc., complete as directed. The cost including 2 coats of wall care putty and one coat of primer and two coats of emulsion paint</p>				
10	WORK TABLE: (WITHOUT 6MM ACRYLIC SOLD SURFACE TOP)	SQM.	3		
	<p>Providing, making and placing in position worktables made in 18mm MDF Exterior Grade Board for all members except table top and 25mm block board for table top and Ready Made Foot Rest, Key Board Tray and vertical supports at approximately every 1350mm length. The Work Table top to have 1mm Laminate as specified and all-round front facia to have 12mm thick MDF Exterior Board lipping along with minimum two coats of NO VOC or LOW VOC duco paint finish/ With PVC Edge lipping and remaining all exposed faces to have 1mm Glossy Laminate as specified. The unexposed surfaces of MDF Exterior Grade members to have 0.8mm Laminate complete as directed. The table to have a three drawer unit for every 1000-1350mm length as per drawing. All faces of MDF Exterior Grade Board to have 12mm MDF Exterior Grade lipping. The cost to include all materials, labour, necessary hardware viz., drawer channels, " W " hinges, SS handles, set locks etc., to a neat job as per directions and directions etc., complete.</p>				
11	STORAGE UNITS: (WITHOUT 6MM ACRYLIC SOLD SURFACE TOP)	SQM.	13		
	<p>Providing, making and placing in position Storage Units with horizontal partitions of 1200mm high abutting wall and 750mm high as back credenza or abutting partition made in 18mm MDF Exterior Grade Board to all members except table top and 25mm block board for table top. The top of the</p>				

	storage unit to have 1mm thick Laminate and the front facia of the storage unit to have 50mm x 12mm MDF Exterior Grade Board finished with minimum two caots of LOW VOC or NOW VOC duco paint. All other exposed faces of the unit to have 1mm Glossy Laminate as specified and all unexposed faces to have 0.8mm Laminate OR NO VOC or LOW VOC enamel painting with putty finish on all unexposed faces including NO VOC or NO VOC duco paint finish for all other exposed surfaces of MDF Exterior Grade members and all necessary hardware viz., 'W' or wing hinges, locks, handles, tower bolts etc., and MDF Exterior Grade beading 36mm x 36mm at top and MDF Exterior Grade edge lipping 18mm x 12mm etc., as per drawings and directions etc., complete.				
12	BRANCH HEAD TABLE: (WITHOUT 6MM ACRYLIC SOLD SURFACE TOP)	Each	1		
	Providing, making and placing in position Executive Table and Side Table of approximate size 2400mm - 2100mm x 900mm x 750mm + 1200mm - 1050mm x 450mm x 750mm with following specifications.				
	(a) Main Table and side Table top and to be made in 25mm block board with 1mm thick Laminate. The front side of the table to have a "C" made with 2 x 18mm thick MDF Exterior Grade Board cladded with 1mm Laminate on the front and the verticals towards the modesty panel. The modesty panel to have 18mm MDF Exterior Grade Board cladded with 1mm Laminate as specified.				
	(b) The "L" shaped table top on the back side to have 50mm edge alround and to be cladded with 12mm MDF Exterior Grade Board finished with minimum two caots of LOW VOC or NOW VOC duco paint.				
	(c) All other members to be with 18mm MDF Exterior Grade Board and all exposed faces of the table to have 1mm Laminate OR 1mm Glossy Laminate OR 12mm thick MDF Exterior Grade Board finished with minimum two caots of LOW VOC or NOW VOC duco paint as specified above to be used. (d) All the edges of 18mm MDF Exterior Grade				

	Board to have 18mm x 12mm MDF Exterior Grade edge lipping.				
	(e)One readymade CPU mobile pedestal.				
	(f)One Molded Key Board Tray with channels etc.,				
	(g)One Three Drawer Unit made with 18mm MDF Exterior Grade Board and 12mm MDF Exterior Grade Board. The unit to have one vertical filing drawer at bottom and two equal drawers on top. The rate to include all necessary hardware viz., telescopic drawer channels, handles, locks, etc., and 18mm x 12mm MDF Exterior Grade edge lipping etc.,				
	(h)One Side Table with shutter unit of 600mm with 2 drawers and two openable shutters made with 18mm MDF Exterior Grade Board and 19mm plywood with necessary hardware viz., 'W 'hinges, handles, locks, tower bolts, etc., and 18mm x 12mm MDF Exterior Grade edge lipping etc.,				
	(i)All the unexposed faces to have 0.8mm Laminate OR minimum two coats of NO VOC or LOW VOC enamel paint with putty finish.				
	(j)Ready Made Modular Foot Rest - 400mm x 350mm x 65mm.				
	The cost to include all materials, labour etc., for a finished item of work as per drawings and directions etc., complete.				
13	OFFICER's EXECUTIVE TABLES: (WITHOUT 6MM ACRYLIC SOLD SURFACE TOP)	Each	2		
	Providing, making and placing in position Executive Table and Side Table of approximate size 1650mm - 1550mm x 750mm x 750mm + 1050mm x 450mm x 750mm with following specifications.				
	(a) Main Table and side Table top and to be made in 25mm block board with 1mm thick Laminate. The front side of the table to have a inverted " U " made with 2 x 18mm thick MDF Exterior Grade Board cladded with 1mm Laminate on the front and the verticals towards the modesty panel. The modesty panel to have 18mm MDF Exterior Grade Board cladded with 1mm Glossy Laminate and 1mm Laminate as specified.				
	(b) The " L " shaped table top on the back side along with side table to have 49mm edge all-round, which is to be achieved by adding a 75mm piece of 18mm MDF Exterior Grade Board to the table top				

	from bottom and this vertical edge is to be clad with 1mm Laminate OR 12mm MDF Exterior Grade Board finished with minimum two coats of LOW VOC or NOW VOC duco paint.				
	(c) All other members to be with 18mm MDF Exterior Grade Board and all exposed faces of the table to have 1mm Glossy Laminate as specified above to be used.				
	(d) All the edges of 18mm MDF Exterior Grade Board to have 18mm x 12mm MDF Exterior Grade edge lipping.				
	(e) One readymade CPU mobile pedestal.				
	(f) One Molded Key Board Tray with channels etc.,				
	(g) One Three Drawer Unit made with 18mm MDF Exterior Grade Board and 12mm MDF Exterior Grade Board. The unit to have one vertical filing drawer at bottom and two equal drawers on top. The rate to include all necessary hardware viz., telescopic drawer channels, handles, locks, etc., and 18mm x 12mm MDF Exterior Grade edge lipping etc.,				
	(h) One Side Table with shutter unit of 600mm, with 2 drawers and two openable shutters made with 18mm MDF Exterior Grade Board with necessary hardware viz., ' W ' hinges, handles, locks, tower bolts, etc., and 18mm x 12mm MDF Exterior Grade edge lipping etc.,				
	(i) All the unexposed faces to have 0.8mm Laminate OR minimum two coats of NO VOC or LOW VOC enamel paint with putty finish.				
	(j) Ready Made Modular Foot Rest - 400mm x 350mm x 65mm.				
	The cost to include all materials, labour etc., for a finished item of work as per drawings and directions etc., complete.				
14	SINGLE WINDOW COUNTERS : (WITHOUT 6MM ACRYLIC SOLD SURFACE TOP)	Each	5		
	Providing, making and placing in position Single Window Counters along with necessary partitions as per item 1.2 above (The partilions will be measured and paid as per item 1.2 i.e., Half Height Partitions) with following specifications and per dimensions specified. The front side of the Single Window Counter to have 8mm x 100mm Fiber Cement Board / Calcium Silicate Board /				

<p>Reinforced Magnesium Silicate Board as Skirting clad with 1mm glossy Laminate (silver color) at bottom.</p> <p>(a) The overall size of each Single Window Counter to be 1650mm - 1500mm x 900mm - 975mm x 750mm + 1050mm x 450mm x 750mm.</p> <p>(b) Tabletop of main table and side table to be made in 25mm block board with 1mm thick Laminate for horizontal surfaces and 1mm glossy laminate for vertical surfaces and double thickness at edges around. The 1mm thick glossy Laminate to continue in the front side with curvature from the front table top to the modesty panel in front with cove lighting provision.</p> <p>(c) All other members to be with 18mm MDF Exterior Grade Board / 2 Nos. of 6mm Flexi Plywood in curvature (which should be achieved with a frame work of 50mm x 50mm sal wood frame to be fixed from the front modesty panel / apron and the bottom of this niche to have provision of cove lighting with LED strips) and all exposed faces of the table to have 1mm thick Laminate for horizontal surfaces and 1mm thick glossy Laminate for vertical surfaces and 12mm thick MDF Exterior Grade Board as specified in the drawing to be used.</p> <p>(d) All the edges of 18mm MDF Exterior Grade Board to have 18mm x 12mm MDF Exterior Grade edge lipping.</p> <p>(e) One readymade CPU mobile pedestal.</p> <p>(f) One Molded Key Board Tray with channels etc.,</p> <p>(g) One Three Drawer Unit made with 18mm MDF Exterior Grade Board and 12mm MDF Exterior Grade Board. The unit to have one vertical filing drawer at bottom and two equal drawers on top. The rate to include all necessary hardware viz., telescopic drawer channels, handles, locks, etc., and 18mm x 12mm MDF Exterior Grade edge lipping etc.,</p>				
--	--	--	--	--

	<p>(h)One Side Table with shutters made with 25mm block board top and 18mm MDF Exterior Grade Board for all other members with necessary hardware viz., 'W 'hinges, SS handles, locks, SS tower bolts, etc., and 18mm x 12mm beech wood edge lipping etc.,</p> <p>(i)All the unexposed faces to have 0.8mm Laminate OR minimum two coats of NO VOC or LOW VOC enamel paint with putty finish.</p> <p>(j)Ready Made Modular Foot Rest - 400mm x 350mm x 65mm.</p> <p>(k) All wooden members to have minimum two coats of NO VOC or LOW VOC duco paint finish. The cost to include the "L "shaped Single Window Counter and to include all materials, hardware, labour for a neat and finish job as per drawings and directions etc., complete.</p>				
15	12MM TOUGHENED GLASS DIVIDERS FOR SINGLE WINDOW COUNTERS:	Each.	4		
	Providing, making and fixing in position 12mm thick toughened clear float glass in the front side of half height partitions of Single Window Counters of approximate size 1250mm x 400mm - 100mmintaperedshape.Alltheedgesoftheglass to be polished for a smooth finish and the glass is to be fixed with "D "brackets. The cost to include all materials, labour, hardware etc., for a neat finished job as per drawings and directions etc., complete.				
16	12MM TOUGHENED GLASS ON TRANSACTION SIDE FOR SINGLE WINDOW COUNTERS:	Each.	5		
	Providing, making and fixing in position 12mm thick clear float glass in the front side of approximate size 1650mm x 450mm with a central cut out of 200mm x 175mm. All the edges of the glass to be polished for a smooth finish and the glass is to be fixed with "D "brackets. The cost to include all materials, labour, hardware etc., for a neat finished job as per drawings and directions etc., complete.				

	The cost to include all materials, labour etc., for a finished item of work as per drawings and directions etc., complete.				
17	FLOOR MOUNTED WRITING DESK:	Each.	2		
	<p>Providing, making and placing in position Wall Mounted Circular Writing Desk 900mm dia x 750mm with following specifications.</p> <p>(a) A Octagonal support boxing is to be made 450mm at floor level tapering upwards to 600mm at 900mm from floor made in 12mm MDF Exterior Grade Board cladded with 1mm Glossy Laminate. A top to be provided at 900mm level from floor to be made with 25mm Block Board cladded with 1mm Glossy Laminate which will have verticals made with 12mm MDF Exterior Grade Board cladded with 1mm Glossy Laminate upto the table top level of 1050mm from floor level.</p> <p>(b) The Writing Desk Circular Top to have 1200mm dia toughened clear float glass with 25mm champered bull nosing all-round.</p> <p>(c) All members to be with 12mm / 18mm MDF Exterior Grade Board and all exposed faces to have 1mm Glossy Laminate as specified.</p> <p>(d) All the edges of 12mm / 18mm MDF Exterior Grade Board to have 18mm x 12mm MDF Exterior Grade edge lipping.</p> <p>(e) All the unexposed faces to have 0.8mm Laminate OR minimum two coats of NO VOC or LOW VOC enamel paint with putty finish.</p> <p>The cost to include all materials, labour etc., for a finished item of work as per drawings and directions etc., complete.</p>				
18	PLASTIC EMULSION PAINTING: With Putty	SQM	80		
	Cleaning the surface of the wall & then applying Two coat of Wall care putty one coat of primer to give smooth finish exactly in line and level & then finally applying one coat primer and two coats of				

	NO VOC or LOW VOC Plastic Emulsion Paint of approved shade to give a neat finish including cost of all materials necessary scaffolding etc., complete for walls & ceiling.				
19	ROLLER BLINDS:	SQM	14		
	Providing and fixing in position of Roller Blinds of approved Fabric (Fabric Cost - RS. 1,000/- per Meter) of Hunter Douglas / Mac / Vista make or approved equivalent of approved shade etc., as directed. (Window opening only considered for measurement. Roller blind should cover entire window opening area without any gap on all sides)				
20	DESIGNER FILM WORK (Itching film):	SQM	24		
	Providing and fixing in position Designer Film with ellipse design on all glasses as per drawings and heights mentioned. The Designer Film is of Harmony / 3M or equivalent approved make. The rate is for a finished item of work etc., complete as directed.				
21	ACP CLADDING:	SQM	16		
	Supplying and fixing aluminium composite cladding (HB-1)with skin material 0.5 mm thick aluminium sheet cover material natural polyethylene aluminium cladding panel fixed with extruded aluminium basis frame (50x25x1.5mm) angle cleats, weather sealants, rivets, GI brackets all as approved, using suitable bolts on structural steel work including necessary accessories complete in all respects including all labour charges etc., complete for finished item of work but excluding cost of structural steel fabrication, scaffolding charges, if any, ACP Cladding - 4 mm thick. ATM room shade codes: Machine Side paneling : Sunrise silver metallic 600 of Alucobond or equivalent Machine Back wall paneling: Ink Blue L481-105899 of Alucobond or equivalent				
	The cost to include all materials, labour etc., for a finished item of work as per drawings and directions etc., complete.				
22	Wicket gate	SQM	6		
	Providing and Fixing wicket gate wherever required with required SS hinges, SS tower bolts, automatic surface mounted spring door closer etc. Rubber wood capping made out of sect. 65 x 15 mm fixed at edges incl. natural polish / painting etc.				

	complete as directed				
23	Night latch	Each	5		
	Providing and fixing night latch with three keys at doors, etc.				
24	Cleaning of Premises	LS	1		
	Deep Cleaning of the premises and dispose the debris, the scope includes cleaning of the electrical, civil, AC works debris and fine cleaning of the existing premises and daily cleaning and maintaining the premises neat and clean.				
25	Buy Back	LS	-1		
	Dismantling and removing the existing Counters, Wall Paneling, Loose Furniture, False Ceiling etc., removing existing plumbing lines if required with proper closing of valves etc., complete and carting away nonservicable material and disposing of all debris to contractors dump yard or approved land fill as directed etc., complete. (single window counters, Storage units, officer tables wooden/aluminum partitions, Except BM table). The scope including arranging the temporary table arrangement during the work is in progress) MINIMUM VALUE= 10000/-				
26	ACRYLIC LOGO	Nos	1		
	Providing SBI Logo & SBI letters 900mm diameter made with 6mm Inky Blue color acrylic sheet with provision for back lighting as per drawings and directions etc., complete.				
	Total Amount	:			
	Less-Discout, if any	:			
	Grand Total (After Discount)	:			

Note: Quoted amount should exclude GST; GST Will be paid extra as per actual .

TENTATIVE LAYOUT FOR INTERIOR WORKS FOR ADB METPALLY BRANCH, RBO GODAVARIKHANI ,AO NIZAMABAD, SBI.

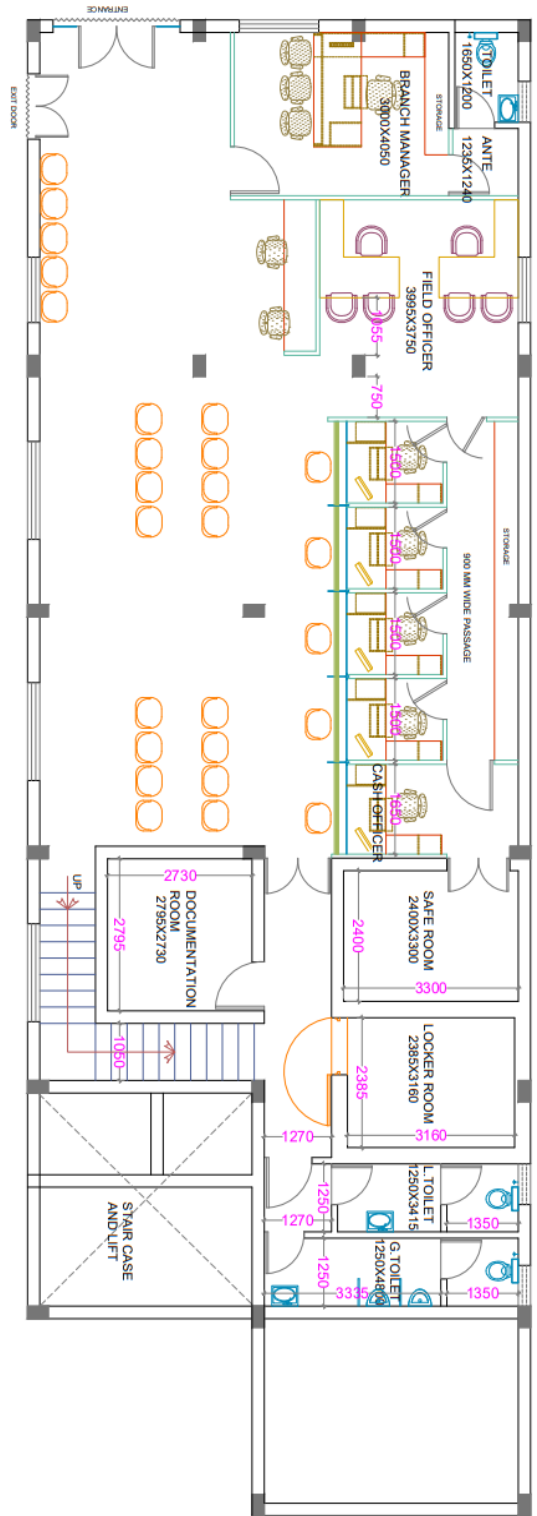

REGIONAL MANAGER	CHIEF MANAGER (COMT)	DESK OFFICER	BRANCH MANAGER	CIVIL ENGINEER
PROPOSED INTERIOR LAYOUT FOR STATE BANK OF INDIA ADB METPALLY BRANCH BRANCH SITUATED AT METPALLY.				
GROUND FLOOR PLAN			OPTION - 03	
			DATE : 09-02-2024	